

**QR**CITRULINA

**PROJETO - COLHEITADEIRA DE MELANCIA**



QR CITRULINA

# OBJETIVOS

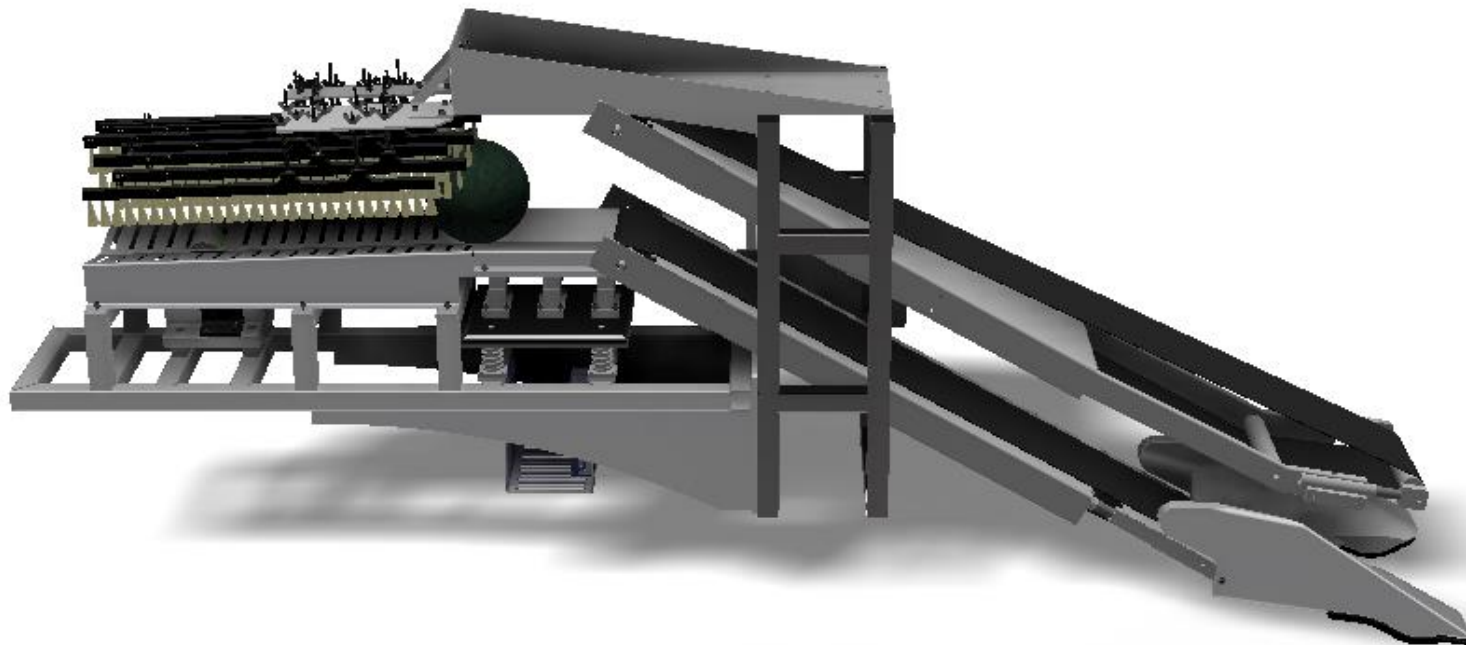

CAPTAÇÃO

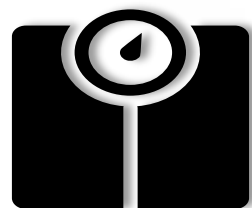

PESAGEM

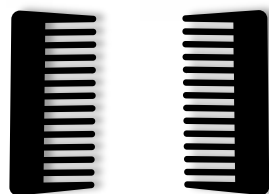

LIMPEZA

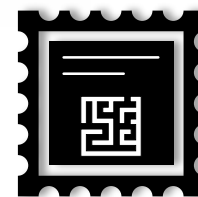

ETIQUETAGEM



QR CITRULINA

# INTRODUÇÃO - Melancia no Brasil

- ❖ No Brasil temos as condições ideais para o cultivo da melancia, durante o ano todo. A partir da década de 1990, a melancia teve sua expansão no mercado, devido ser uma opção para alimentos de baixas calorias.

## COLHEITA DE MELANCIA NO BRASIL

**2,2 M**  
TONELADAS

Quantidade de  
melancias  
produzidas

**1,325 BI**  
REAIS

Valor da produção de  
melancias

**102.412**  
HECTARES

Área plantada ou  
destinada à colheita

Fonte: IBGE - Produção de Melancias no Brasil, em 2018.



# PROBLEMÁTICA

 **Esforços excessivos**



Fonte: globo.com - Foto: Marcelino Neto - 2014

 **Problemas ergonômicos  
(Lombalgia)**



Fonte: reumatologia.org.br



QR CITRULINA

# PROBLEMÁTICA

## ❑ Sistema de Limpeza

➤ Agregar valor ao fruto

➤ Garantir a etiquetagem



## ❑ Sistema de Etiquetagem

➤ Obrigatoriedade de etiquetagem em frutas





QR CITRULINA

# PROBLEMÁTICA

## ❑ Sistema de Captação

- ❖ Otimização dos projetos anteriores



Fonte: EasyCrop, 2018



Fonte: Citrullus, 2018

## ❑ Sistema de Pesagem

- ❖ Alto custo para o pequeno produtor
- ❖ Pesagem realizada em terceiros



Fonte: Youtube



# SISTEMAS PARA ESTUDO

## CAPTAÇÃO

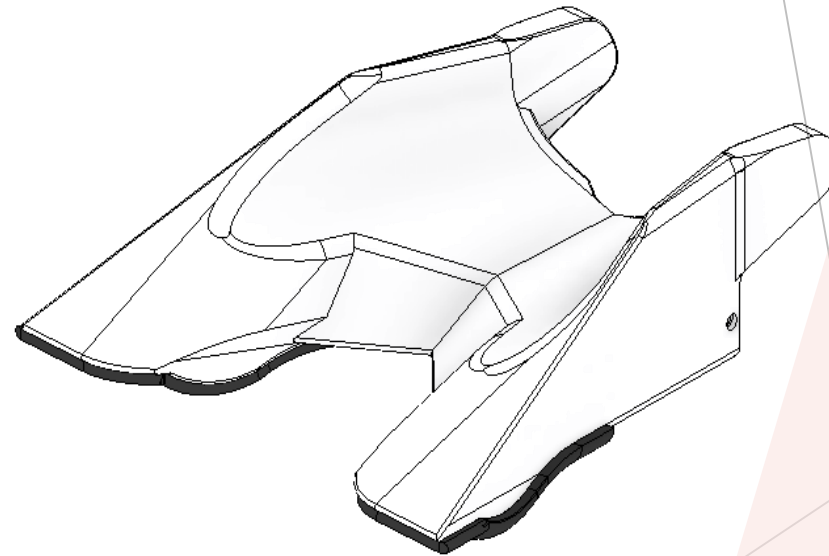
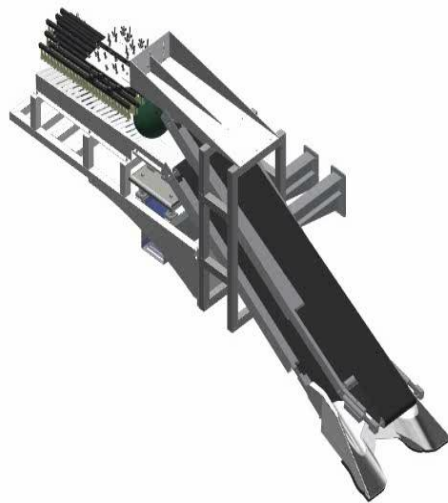



QR CITRULINA

# SISTEMAS PARA ESTUDO

## PESAGEM

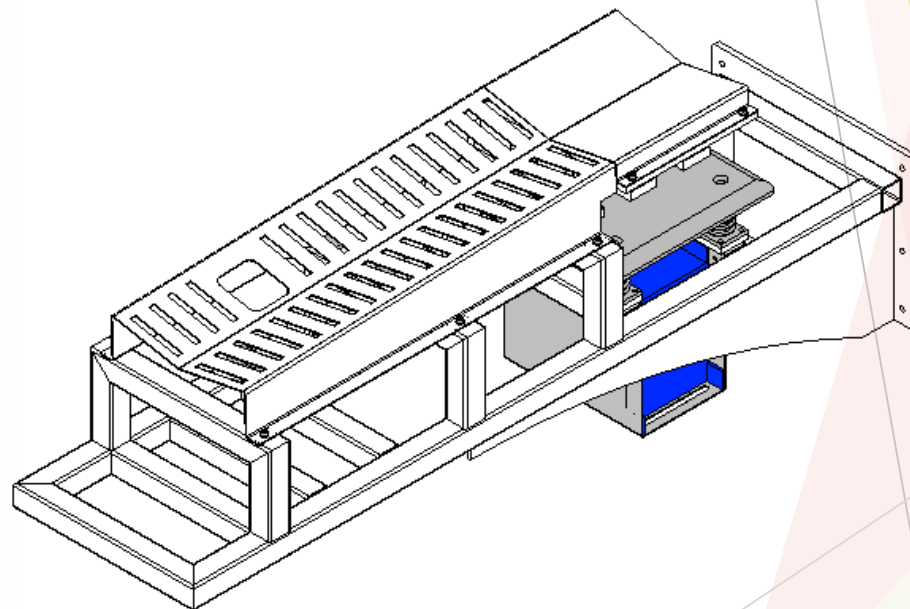
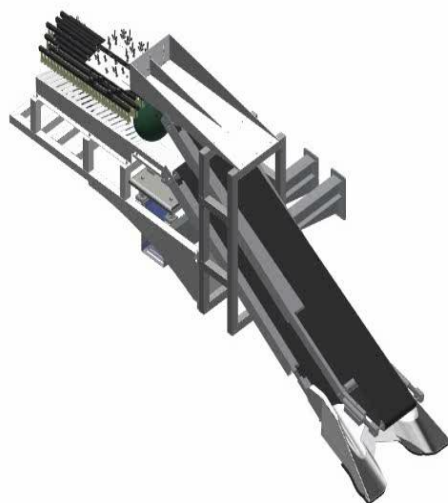





QR CITRULINA

# SISTEMAS PARA ESTUDO

## LIMPEZA

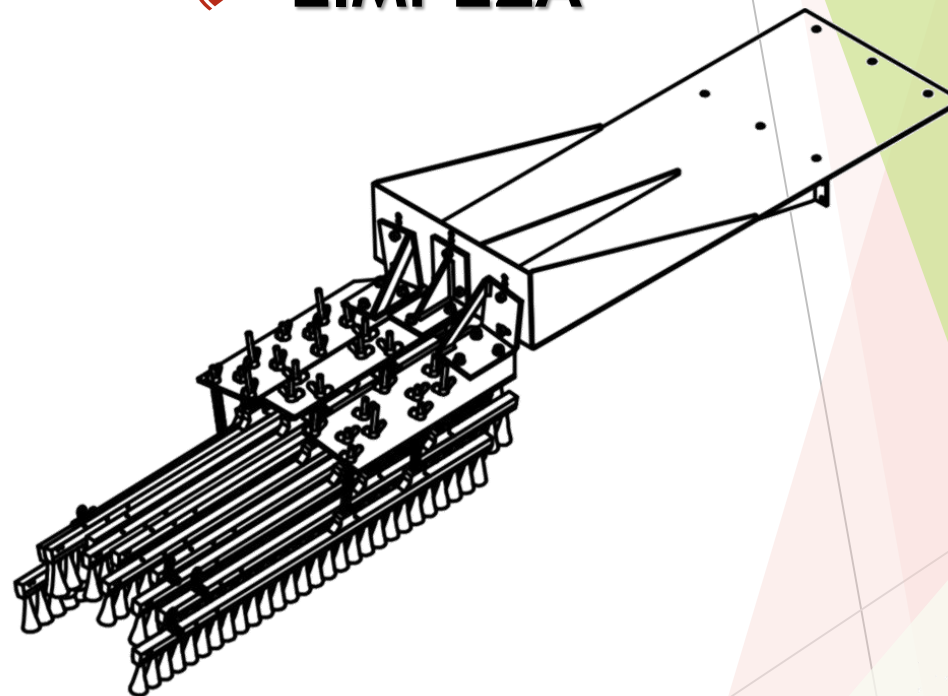
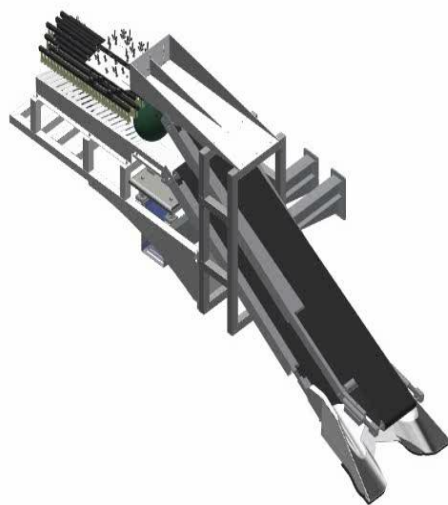



# SISTEMAS PARA ESTUDO

## ETIQUETAGEM

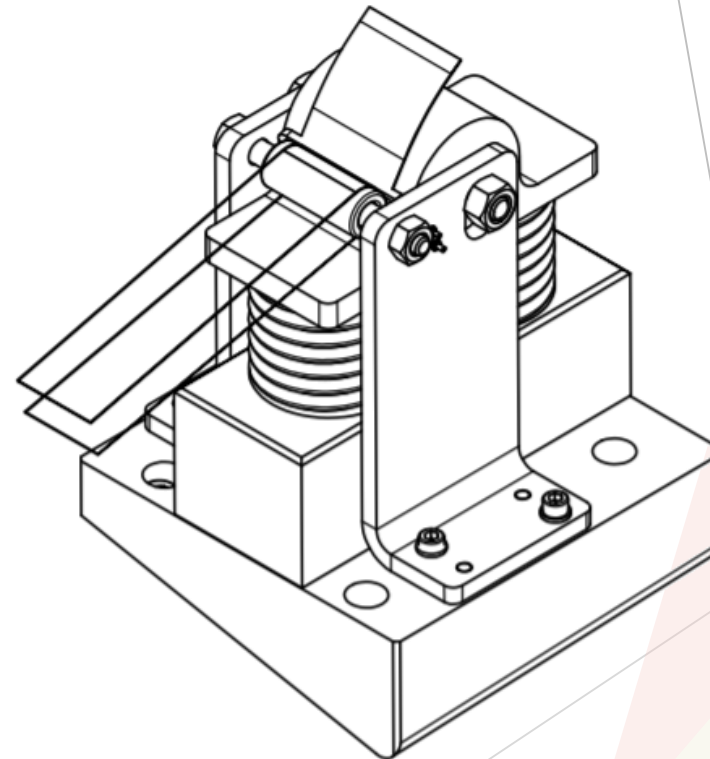
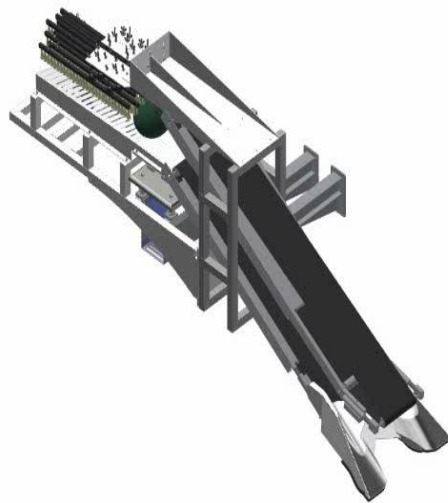



# ANÁLISE PESO

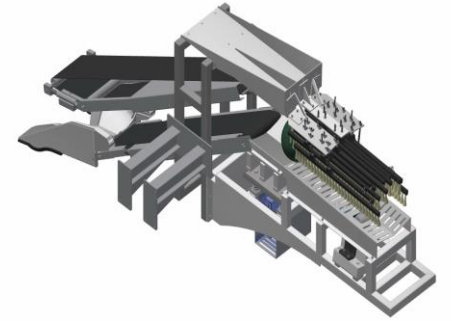

Simulação e verificação do peso dos sistemas Qr\_Citrulina ao acoplamento Citrullus com o trator.

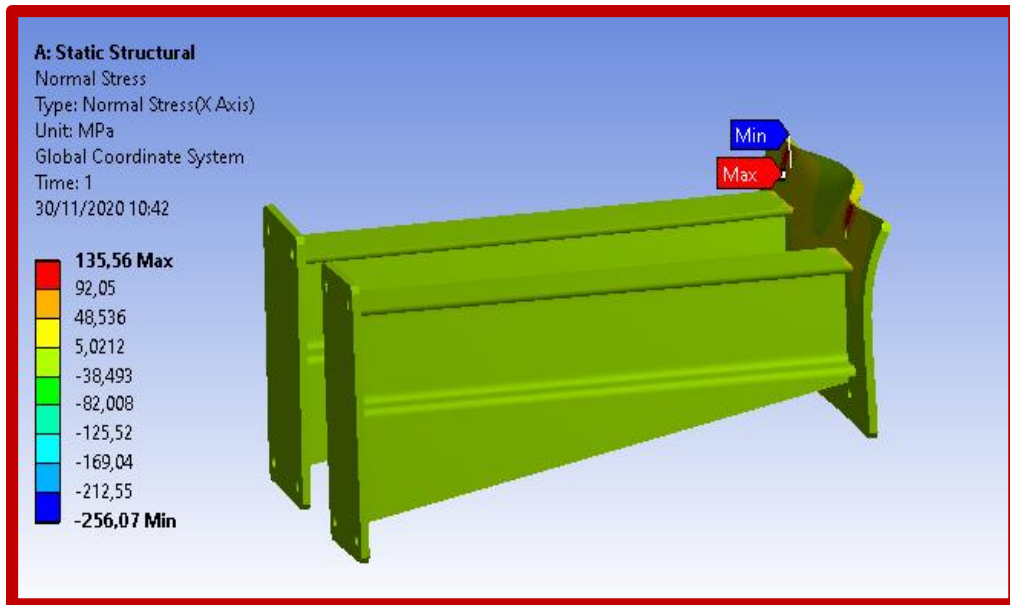

Fonte: Autor

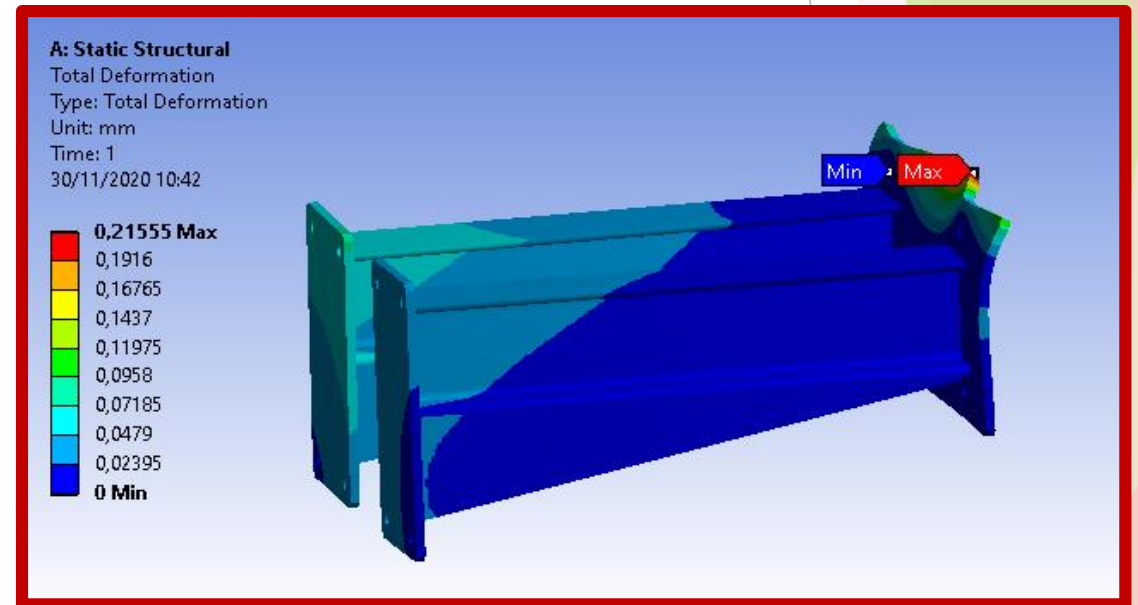

Fonte: Autor



# SISTEMAS PARA ESTUDO

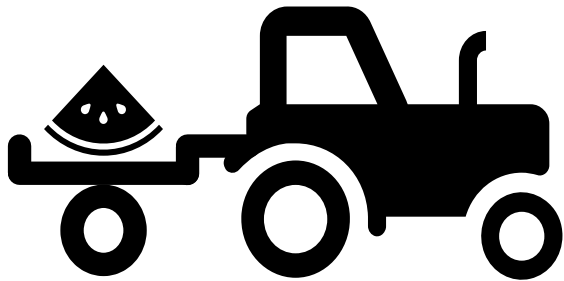

CAPTAÇÃO

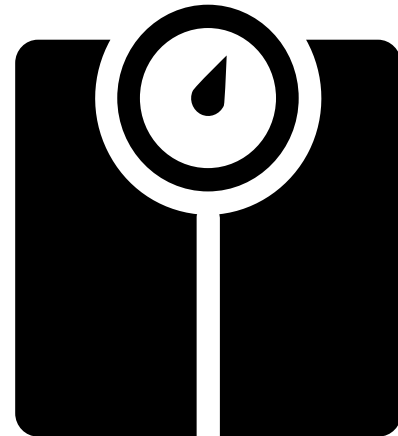

PESAGEM

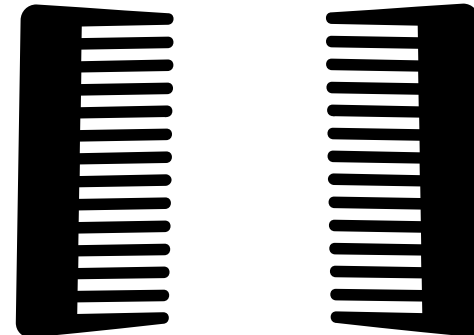

LIMPEZA

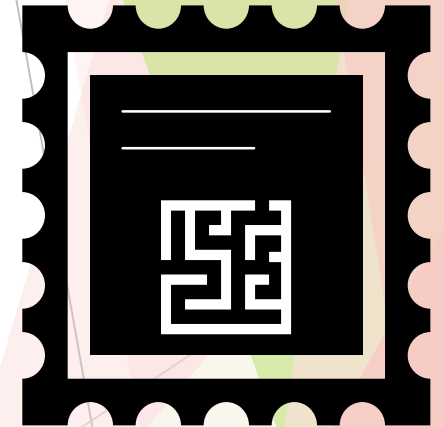

ETIQUETAGEM



QRCITRULINA

# SISTEMA DE CAPTAÇÃO

## □ PROJETOS ANTERIORES

E  
A  
S  
Y  
C  
R  
O  
P

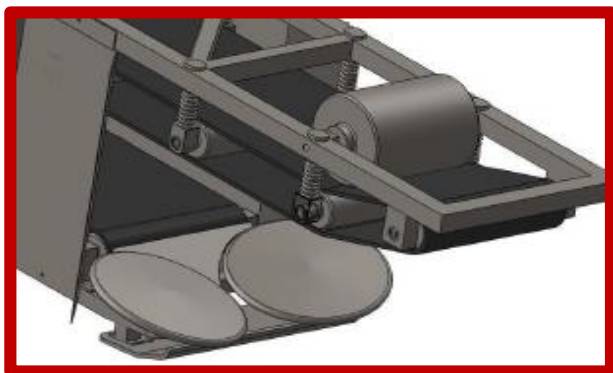

Fonte: TCC - EasyCrop, 2018

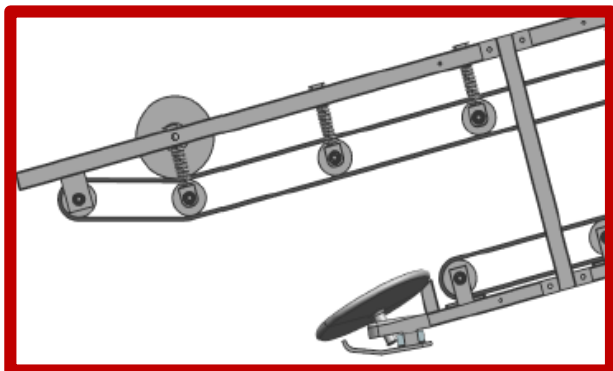

Fonte: TCC - EasyCrop, 2018

C  
I  
T  
R  
U  
L  
L  
U  
S



Fonte: TCC - CITRULLUS 2019

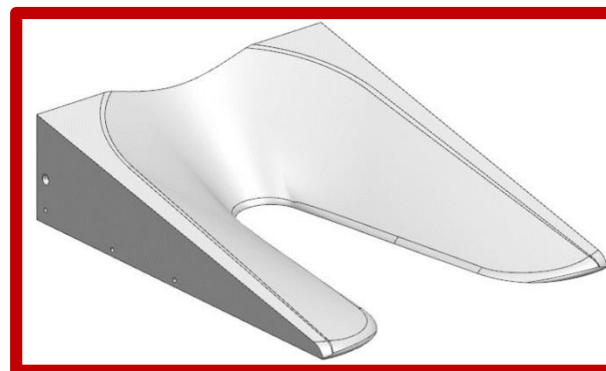

Fonte: TCC - CITRULLUS 2019



Engenharia



# SISTEMA DE CAPTAÇÃO - EM ESTUDO

- Geometria do Captor otimizada.
- Afunilamento do canal de captação.
- Direcionamento do fruto.

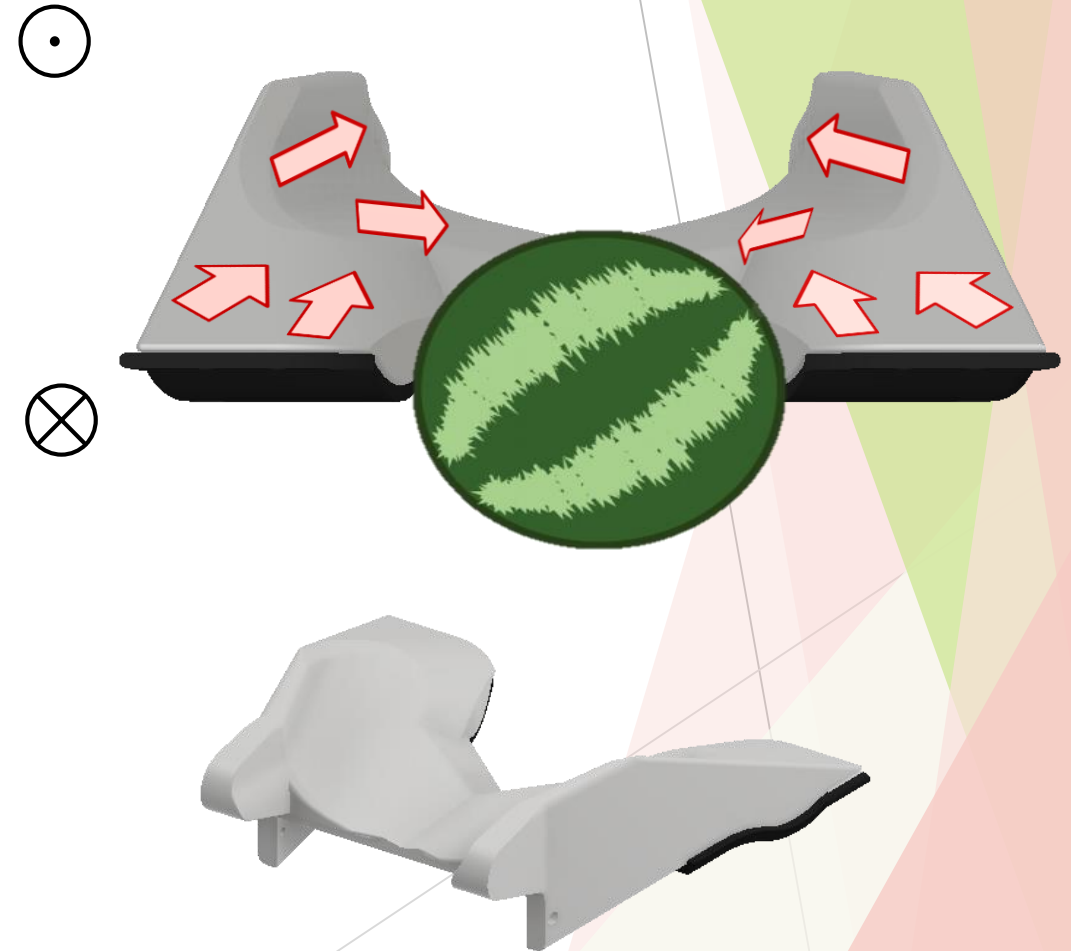



# SISTEMA DE CAPTAÇÃO - EM ESTUDO

- Proteção para o captor
- Fixação com parafusos
- Intercambiável quando necessário

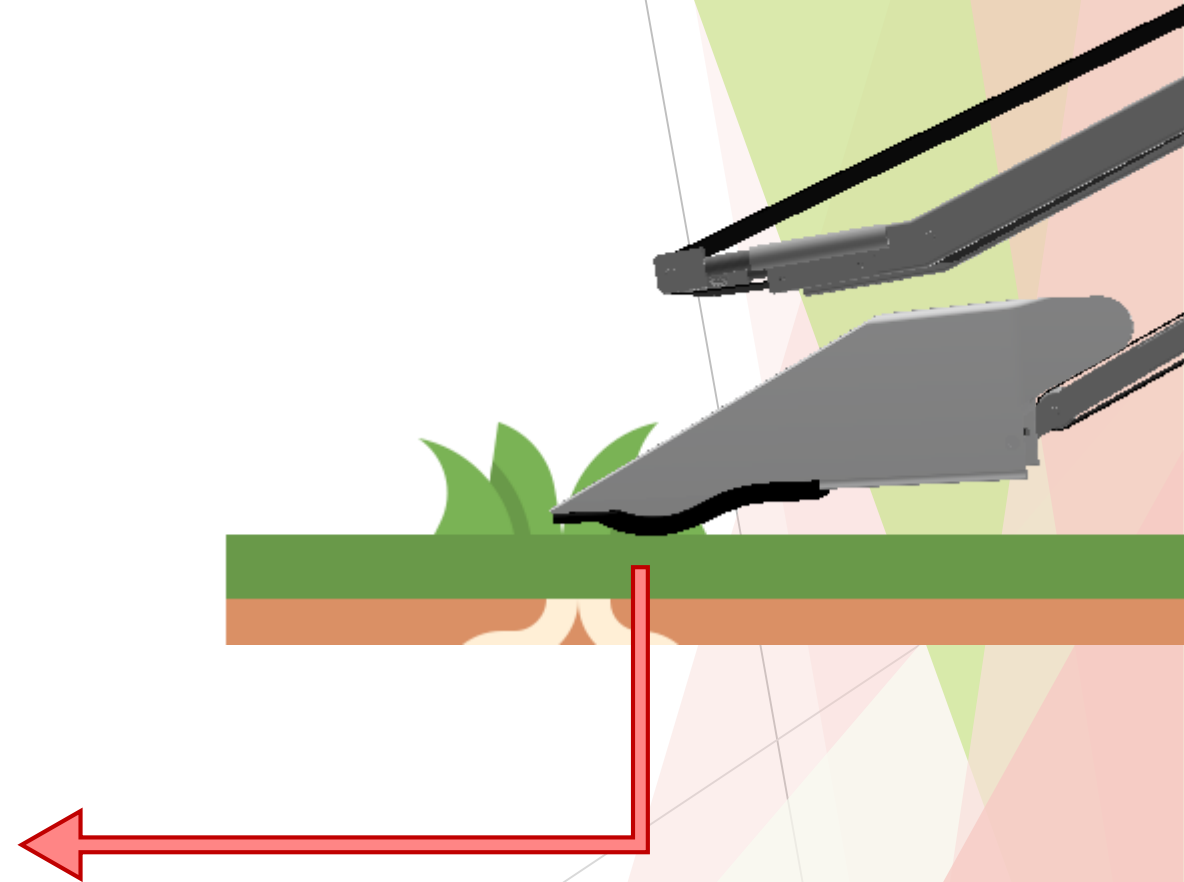
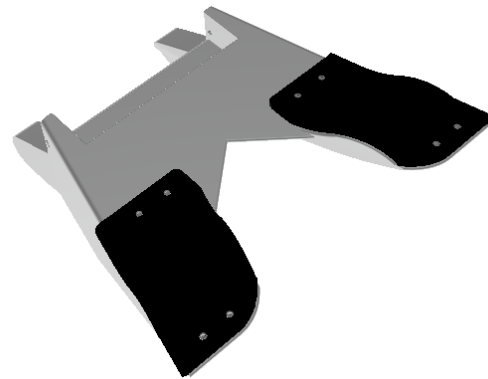



QR CITRULINA

# SISTEMA DE CAPTAÇÃO - EM ESTUDO

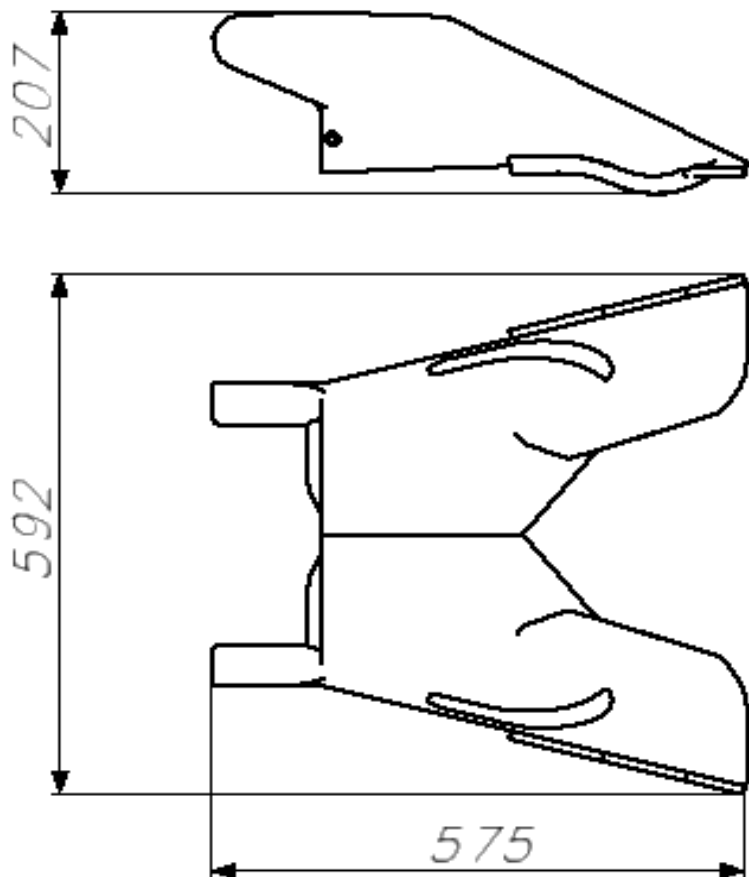

- ◆ Dimensões básicas do sistema de captação
- ◆ O captor será construído em Alumínio
- ◆ Peso aproximado de 31,4 kg





QR CITRULINA

# SISTEMA DE CAPTAÇÃO

## ► Dinâmica do Sistema de Captação



Fonte: Autor

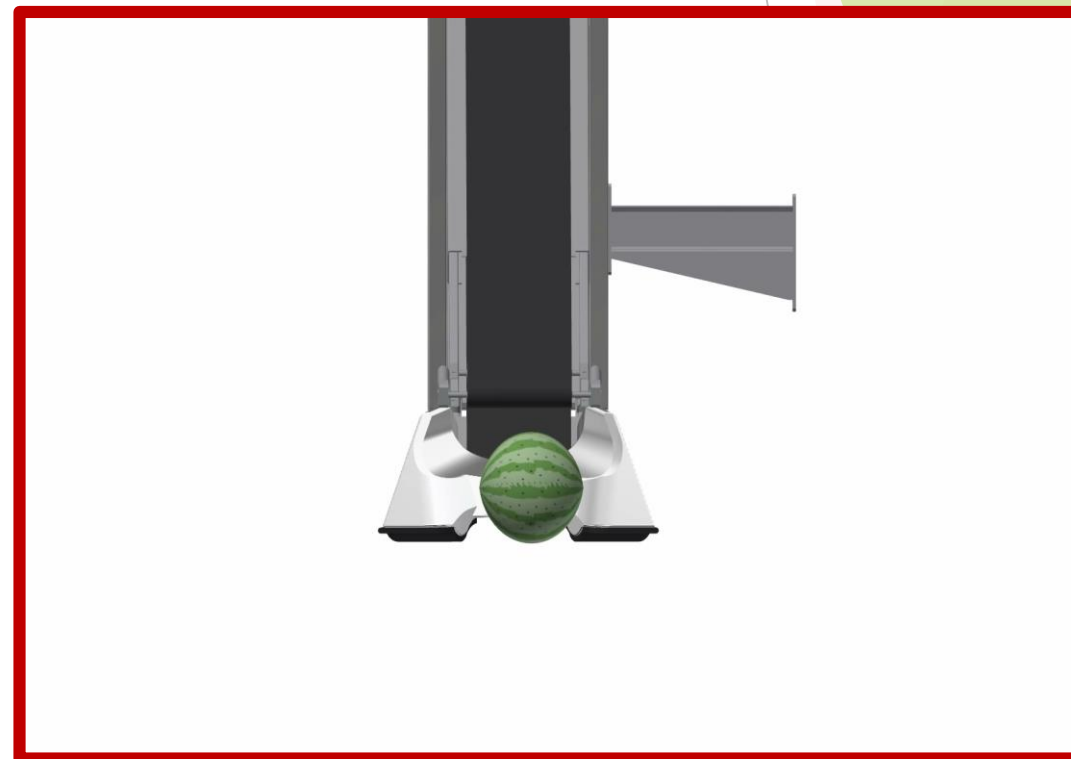

Fonte: Autor



# SISTEMAS PARA ESTUDO

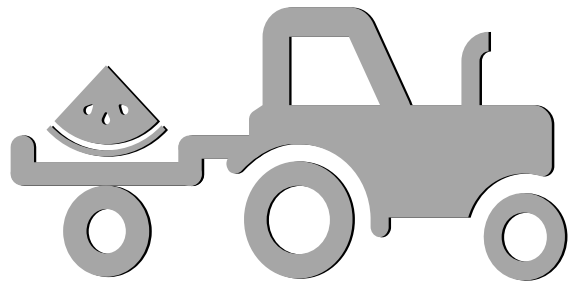

CAPTAÇÃO

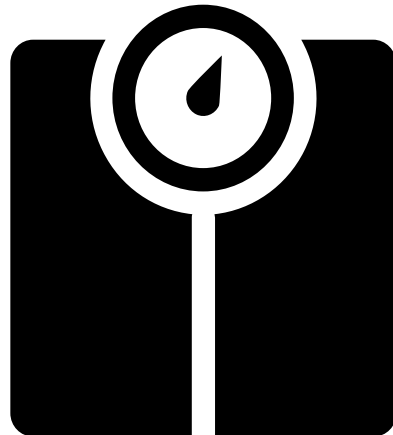

PESAGEM

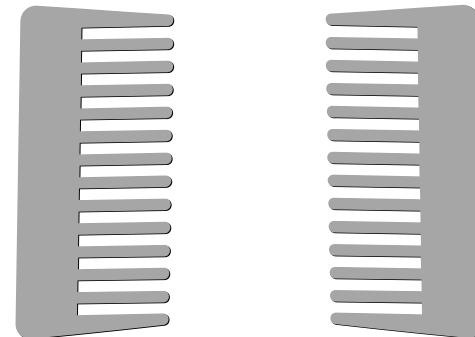

LIMPEZA

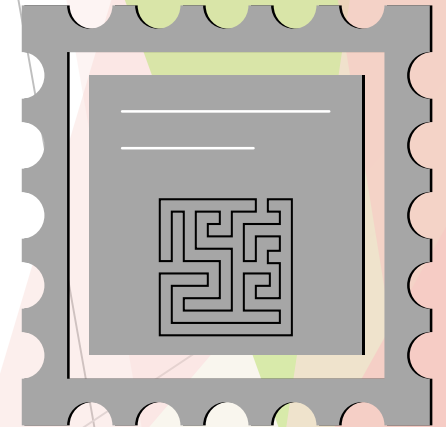

ETIQUETAGEM



QR CITRULINA

# SISTEMA DE PESAGEM

## ❑ Sistema de Pesagem - Proposto

❖ Sistema composto por três células de carga.

❖ Design prismático guiando a melancia;

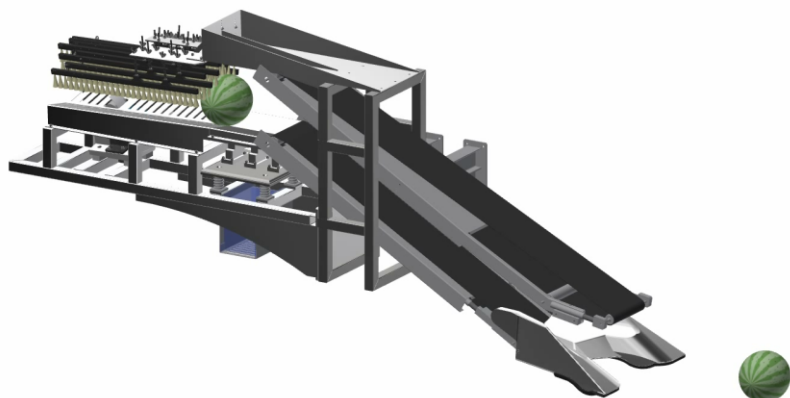

Fonte: Autor



Fonte: [www.hbm.com/pt/4824/fit5a-celula-digital-de-carga-o-coracao-das-balancas/](http://www.hbm.com/pt/4824/fit5a-celula-digital-de-carga-o-coracao-das-balancas/)

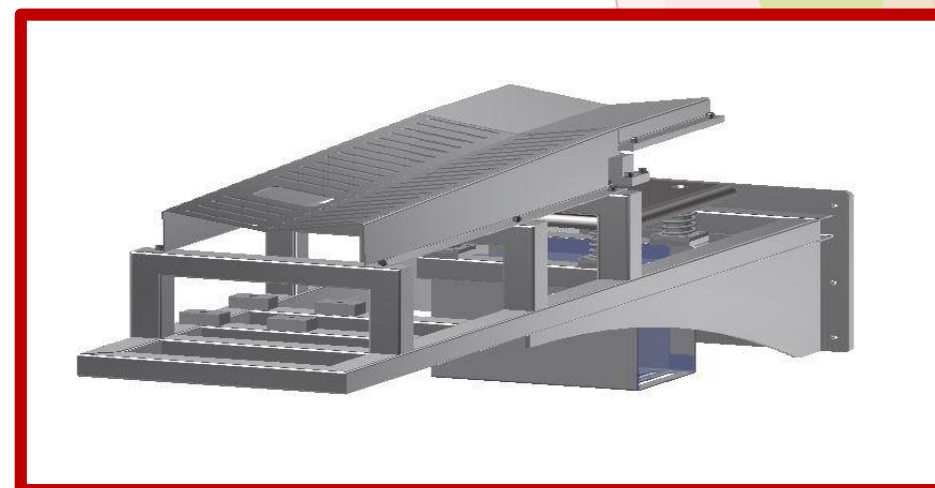

Fonte: Autor



QR CITRULINA

# SISTEMA DE PESAGEM

## ❑ Sistema de Pesagem

📡 MESA ANTIVIBRAÇÃO

📡 CÉLULA DE CARGA (HBM FIT 5A)



Fonte: Autor

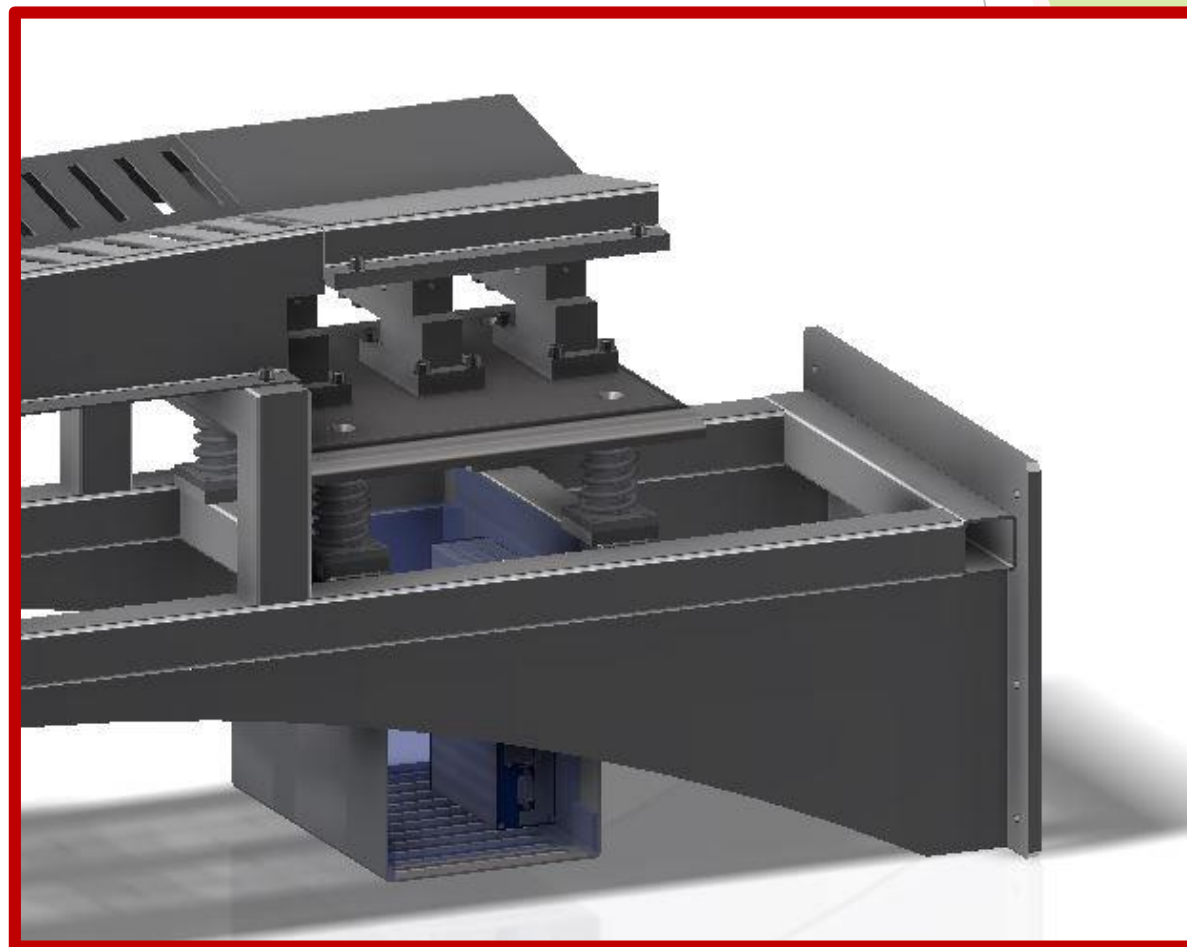

Fonte: Autor



Engenharia



QR CITRULINA

# SISTEMA DE PESAGEM

## ❑ Sistema de Pesagem

### Célula de Carga FIT 5 A Fornecedor HBM



### Special features

- Accuracy class C3 with OIML R60 test report
- Maximum capacities 5 kg ... 50 kg
- Off-center load compensated (OIML R76)
- Dosing mode
- 4 limit value switches
- Trigger mode (external or level)
- Automatic parameterization for dynamic applications
- Stainless steel
- Integral overload protection
- Degree of protection IP68/IP69K
- PC software for parameter setup and dynamic analysis
- Various options and accessories are available

Fonte: [www.hbm.com/pt/4824/fit5a-celula-digital-de-carga-o-coracao-das-balancas/](http://www.hbm.com/pt/4824/fit5a-celula-digital-de-carga-o-coracao-das-balancas/)



Engenharia



QR CITRULINA

# SISTEMA DE PESAGEM

## ❑ Sistema de Pesagem

### 📡 Aquisição e registro de dados

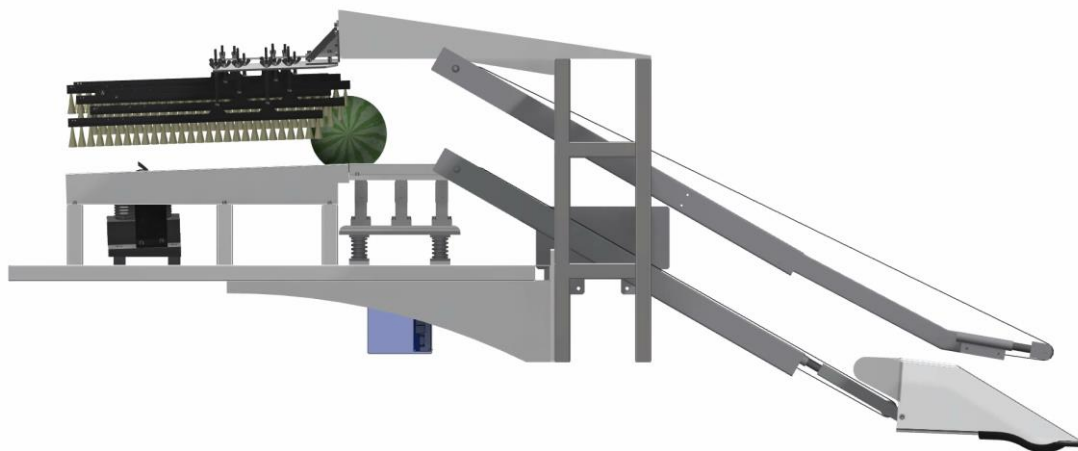

Fonte: Autor



Fonte: [www.hbm.com/pt/2128/quantumx-sistema-de-aquisicao-de-dados-compacto-universal/](http://www.hbm.com/pt/2128/quantumx-sistema-de-aquisicao-de-dados-compacto-universal/)



QR CITRULINA

# SISTEMA DE PESAGEM

## Dimensões básicas do sistema de pesagem

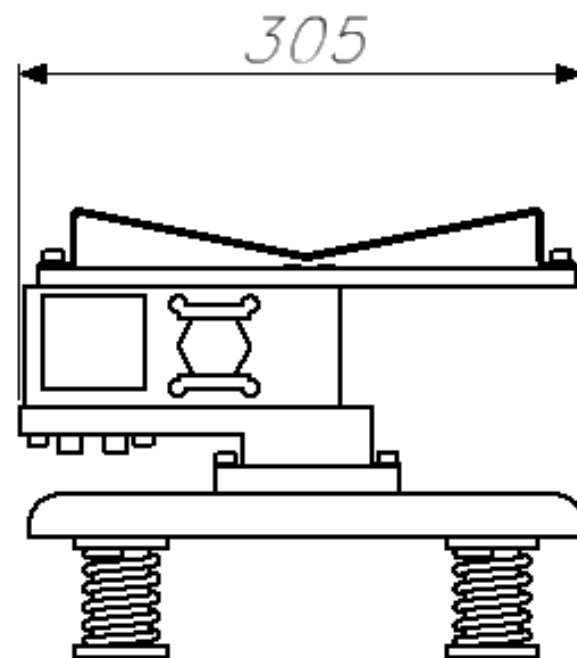
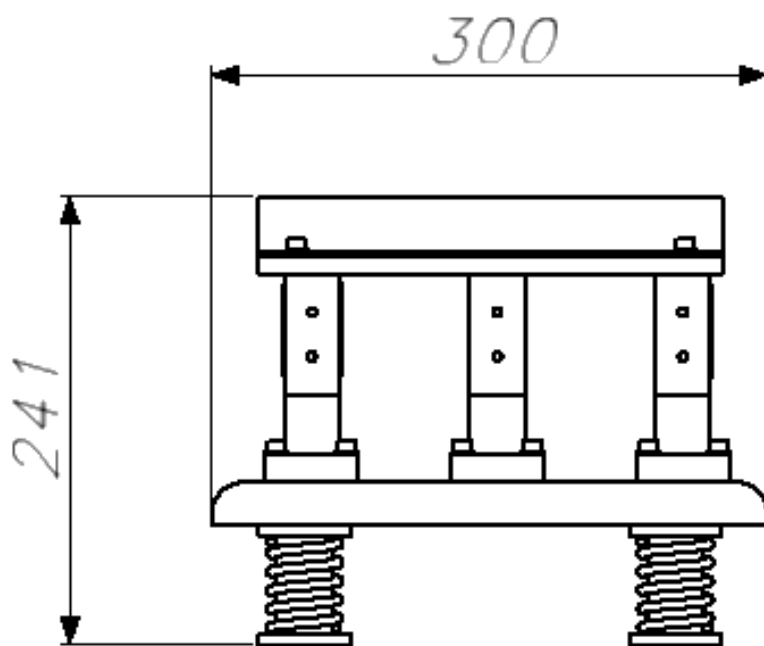



QR CITRULINA

# SISTEMA DE PESAGEM

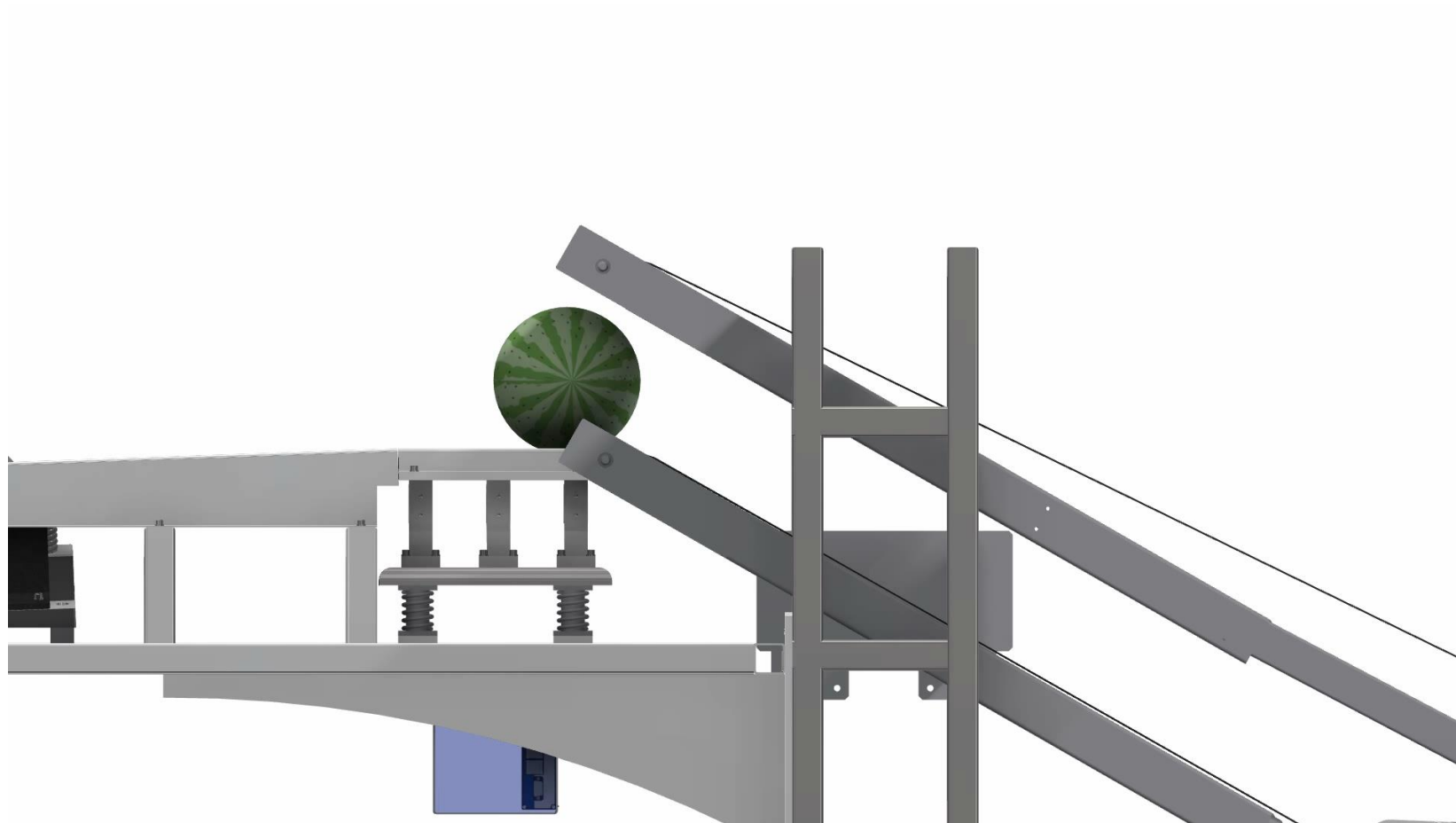

Engenharia





# SISTEMAS PARA ESTUDO

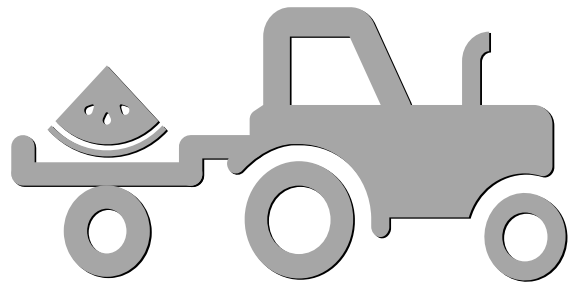

CAPTAÇÃO

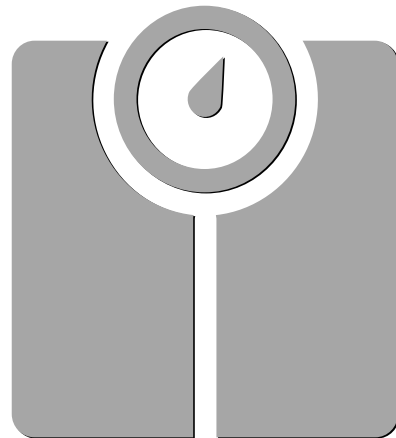

PESAGEM

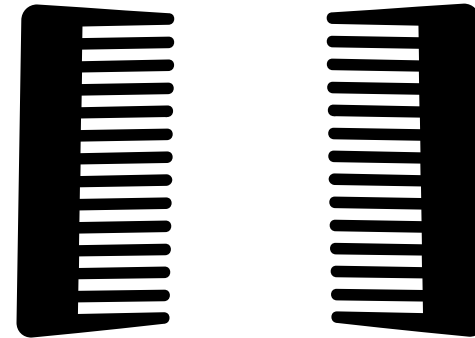

LIMPEZA

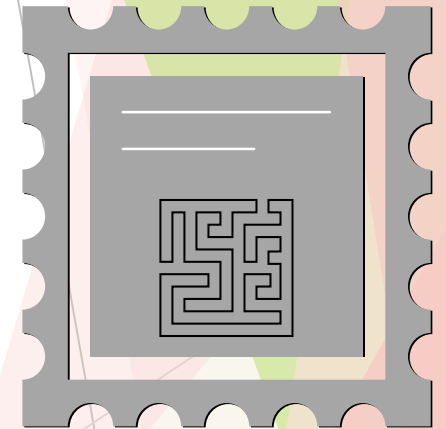

ETIQUETAGEM



# SISTEMA DE LIMPEZA

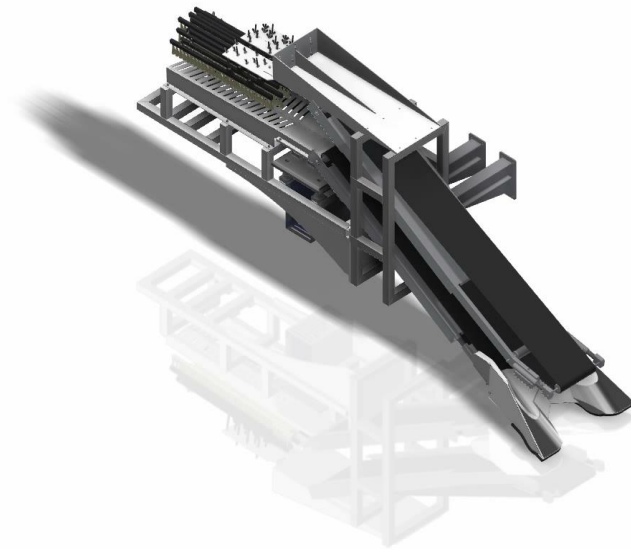
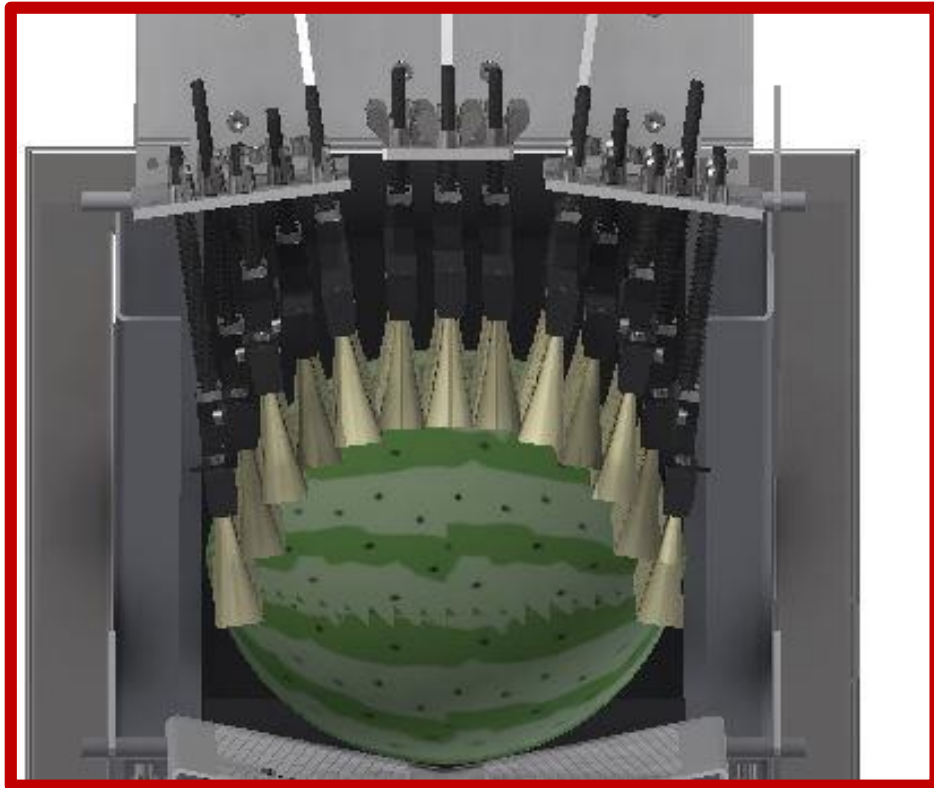

Fonte: Autor



QR CITRULINA

# SISTEMA DE LIMPEZA

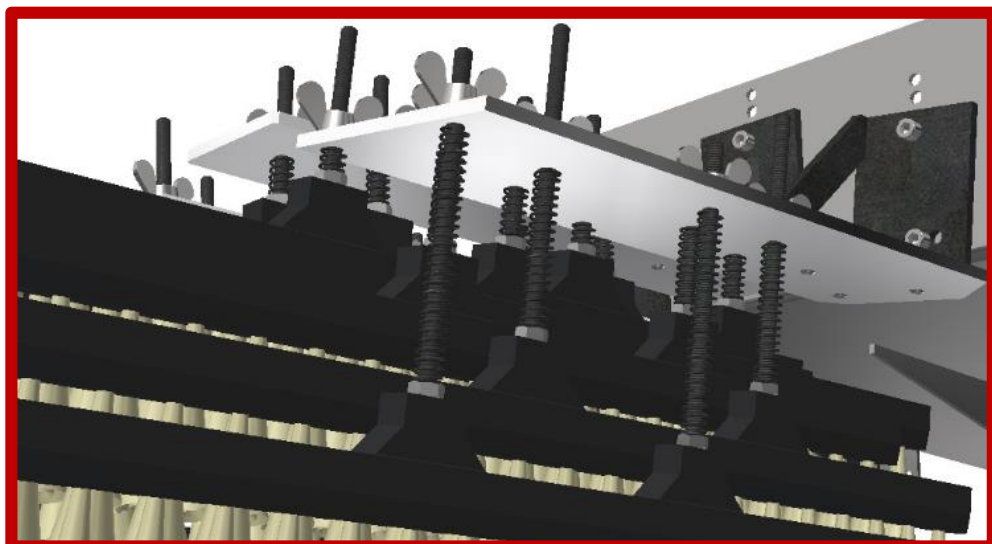

Fonte: Autor

## SISTEMA COM REGULAGEM DE ALTURA DAS CERDAS

Fonte: Autor

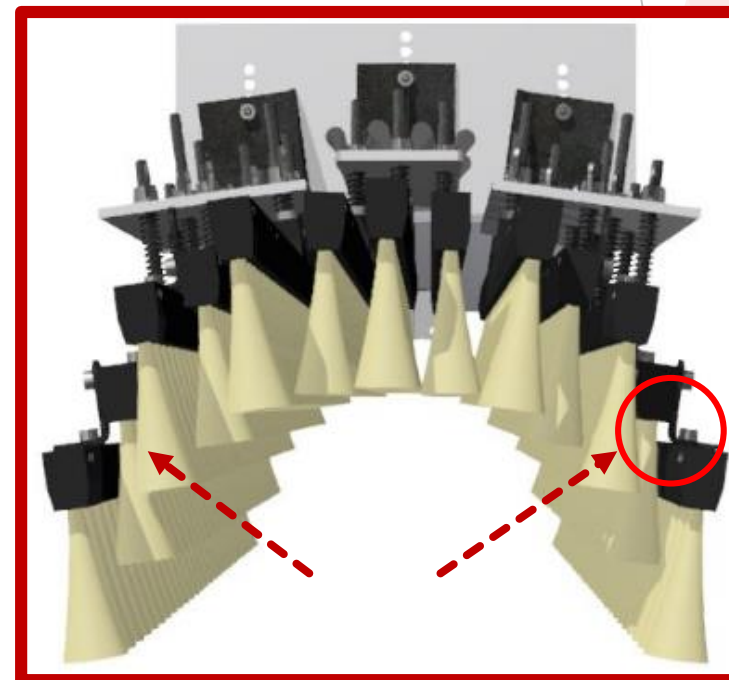

## CERDAS COMPACTADAS COM UNIÃO

IMPOSSIBILIDADE DE GERAR MOMENTO NAS HASTES



Engenharia



QR CITRULINA

# SISTEMA DE LIMPEZA - EM ESTUDO

## SISTEMA COM A BASE EM ÂNGULO

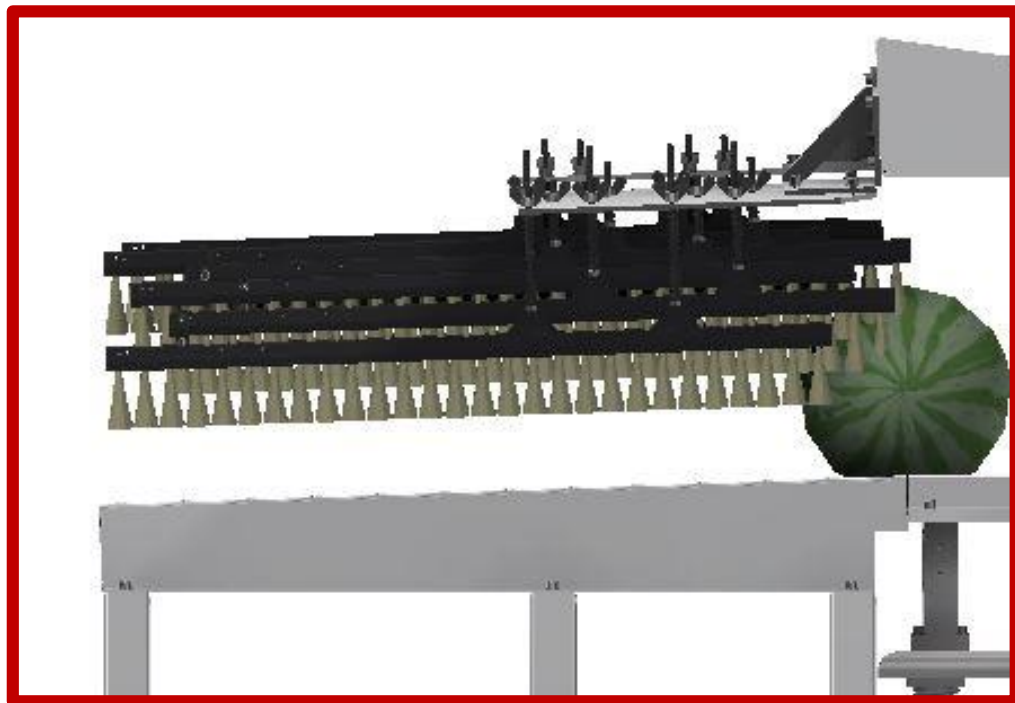

Fonte: Autor

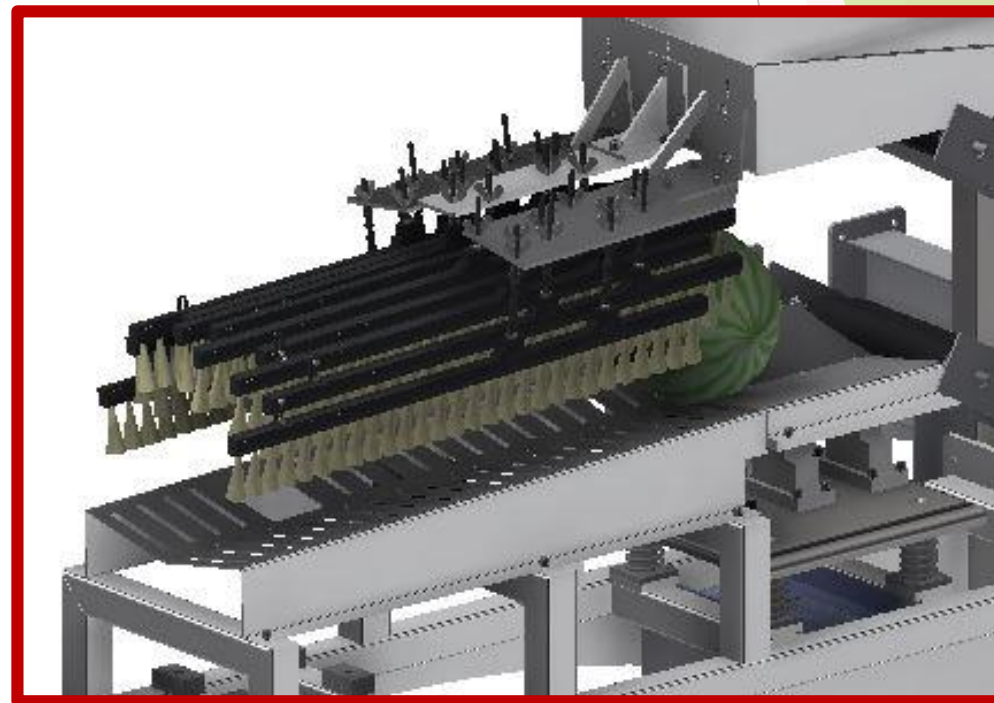

Fonte: Autor



# SISTEMA DE LIMPEZA

## □ Diagrama de corpo livre

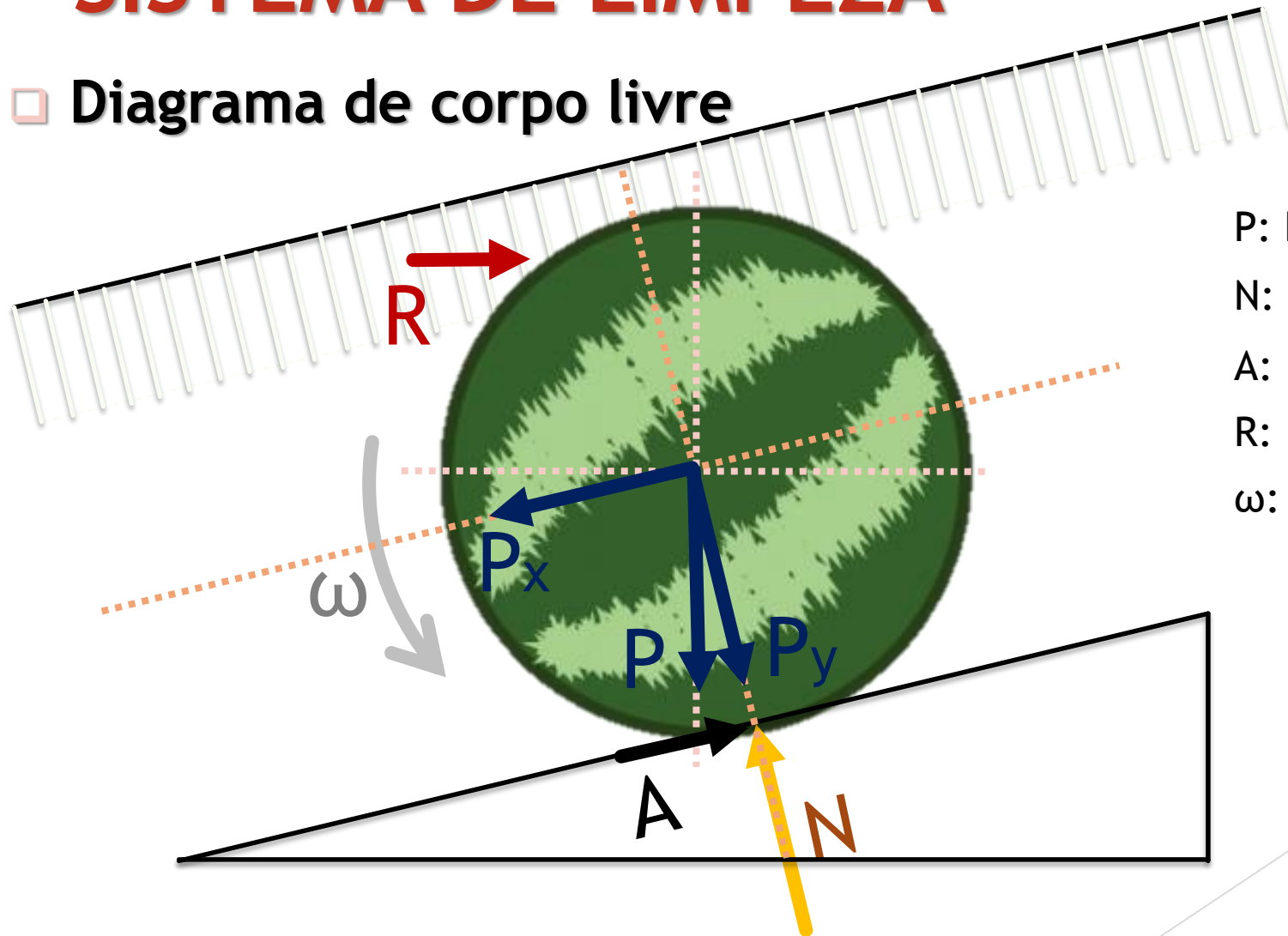

P: Força peso

N: Força normal

A: Força de atrito

R: Força de reação às cerdas

$\omega$ : Velocidade angular



QR CITRULINA

# SISTEMA DE LIMPEZA

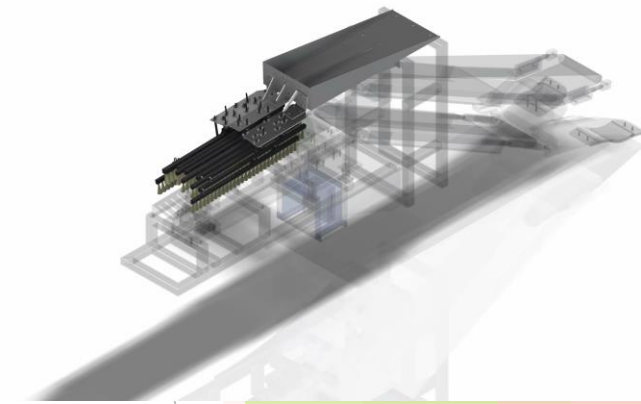

## Simulação da Estrutura da Limpeza

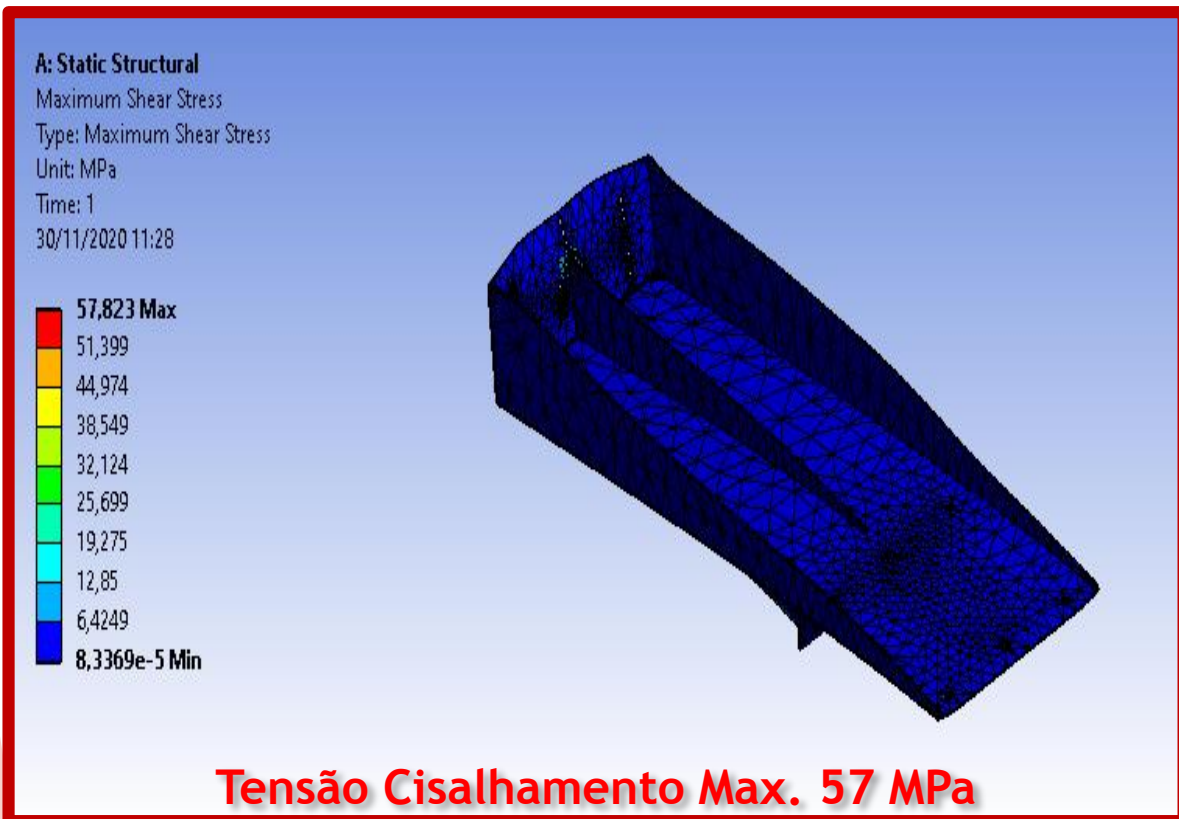

Fonte: Autor

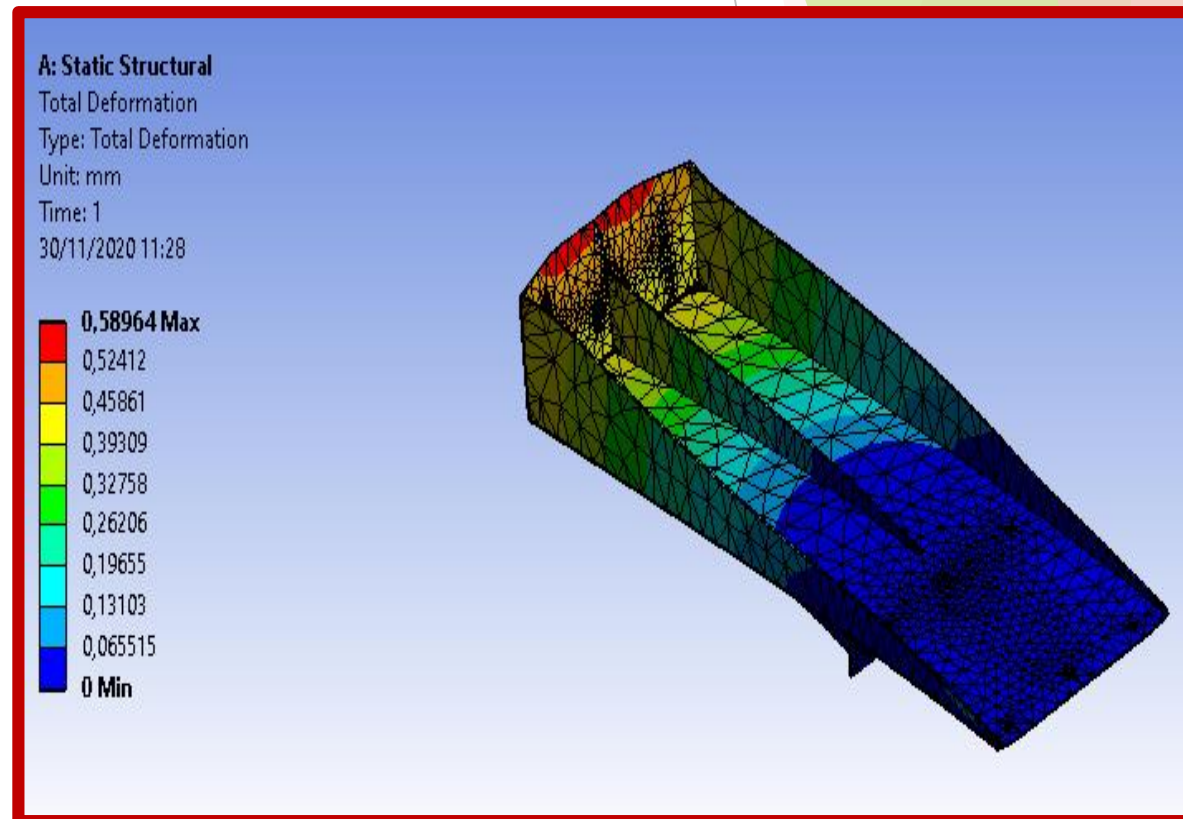



# SISTEMA DE LIMPEZA



## Simulação da Estrutura da Limpeza

A: Static Structural  
Equivalent Stress  
Type: Equivalent (von-Mises) Stress  
Unit: MPa  
Time: 1  
30/11/2020 11:27

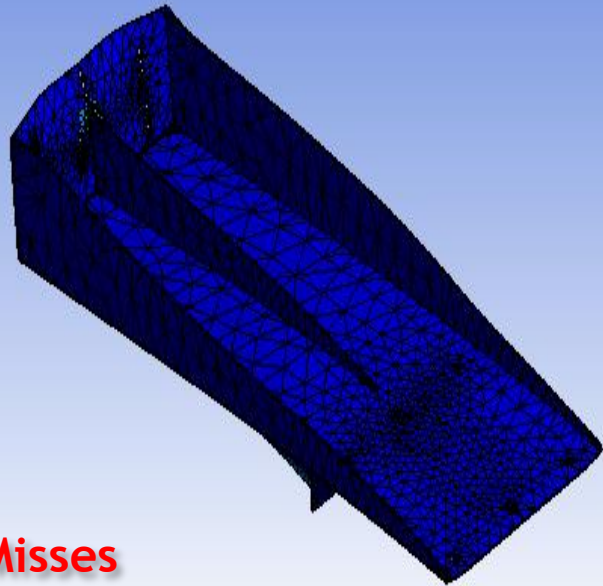
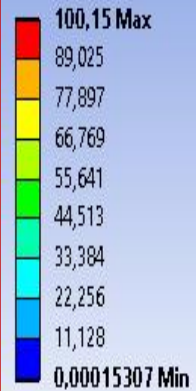

**Von Misses**  
**100 MPa**

Fonte: Autor

A: Static Structural  
Normal Stress  
Type: Normal Stress(X Axis)  
Unit: MPa  
Global Coordinate System  
Time: 1  
30/11/2020 11:27

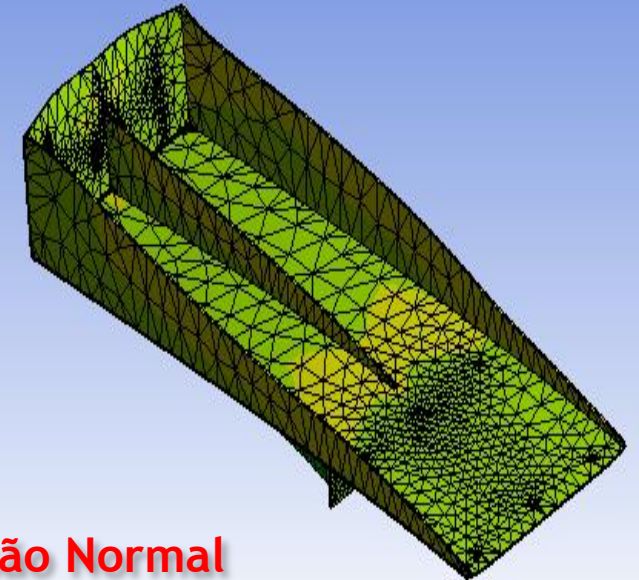
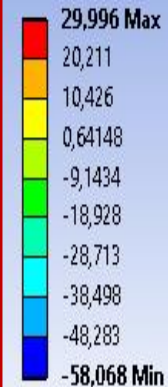

**Tensão Normal**  
**30 MPa**

Fonte: Autor



# SISTEMA DE LIMPEZA

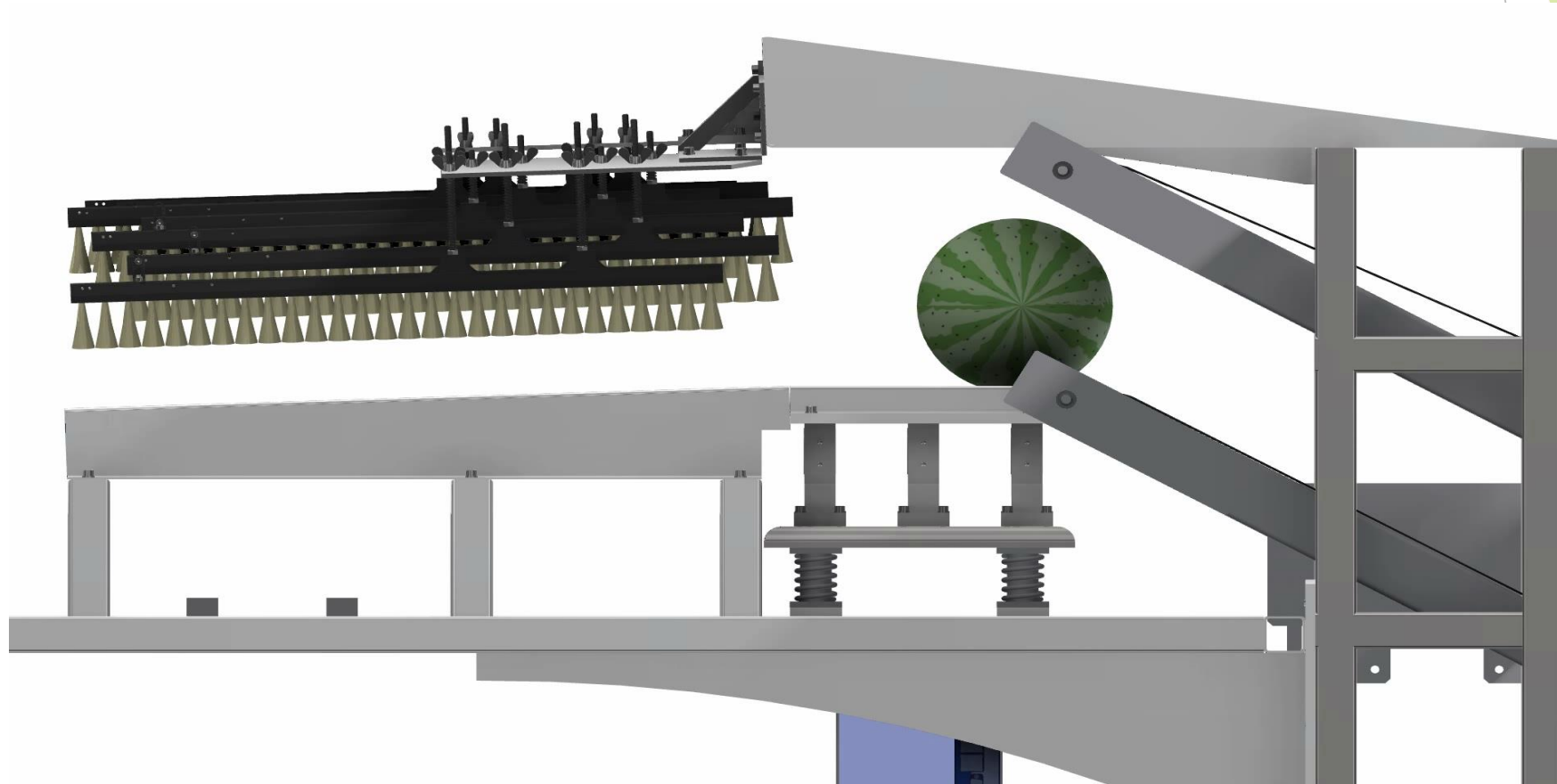

\*Video meramente ilustrativo





# SISTEMAS PARA ESTUDO

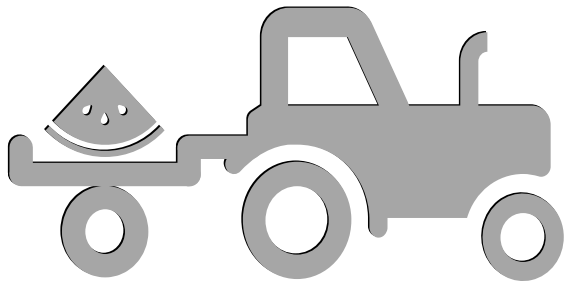

CAPTAÇÃO

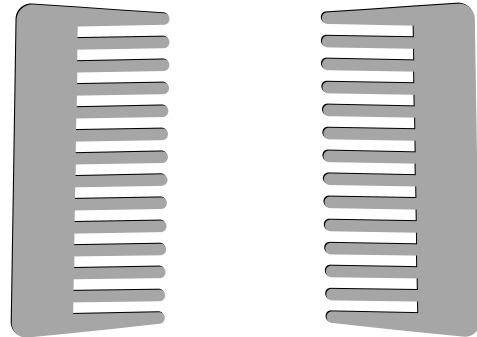

LIMPEZA

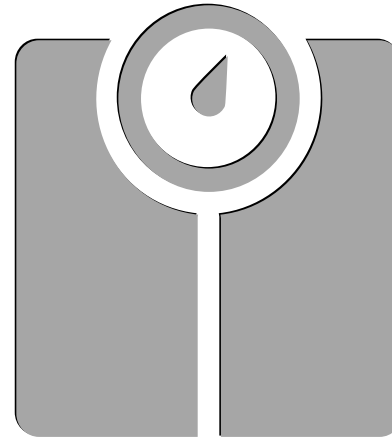

PESAGEM

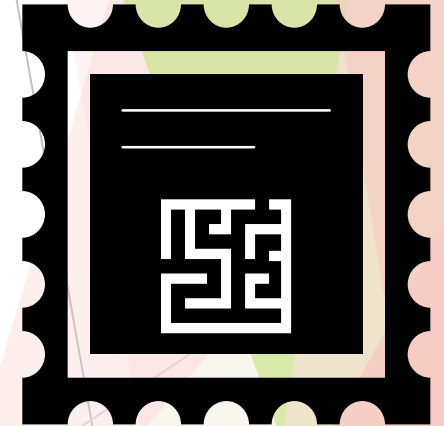

ETIQUETAGEM



QR CITRULINA

# SISTEMA DE ETIQUETAGEM

▶ A etiquetagem será realizada logo após o sistema de Limpeza.

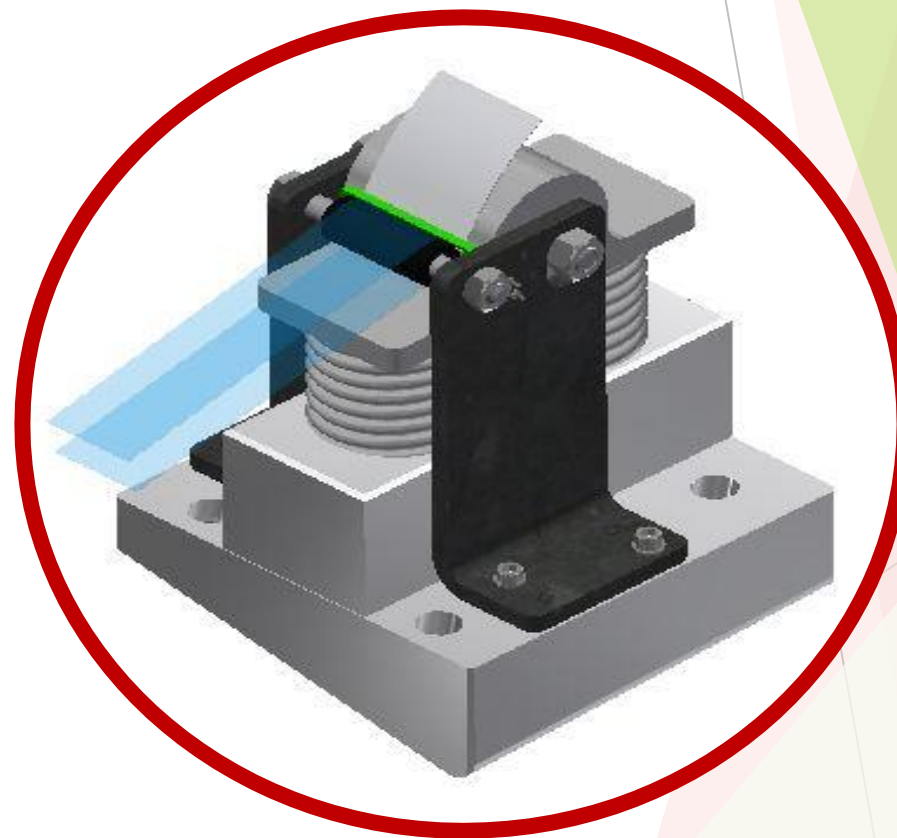
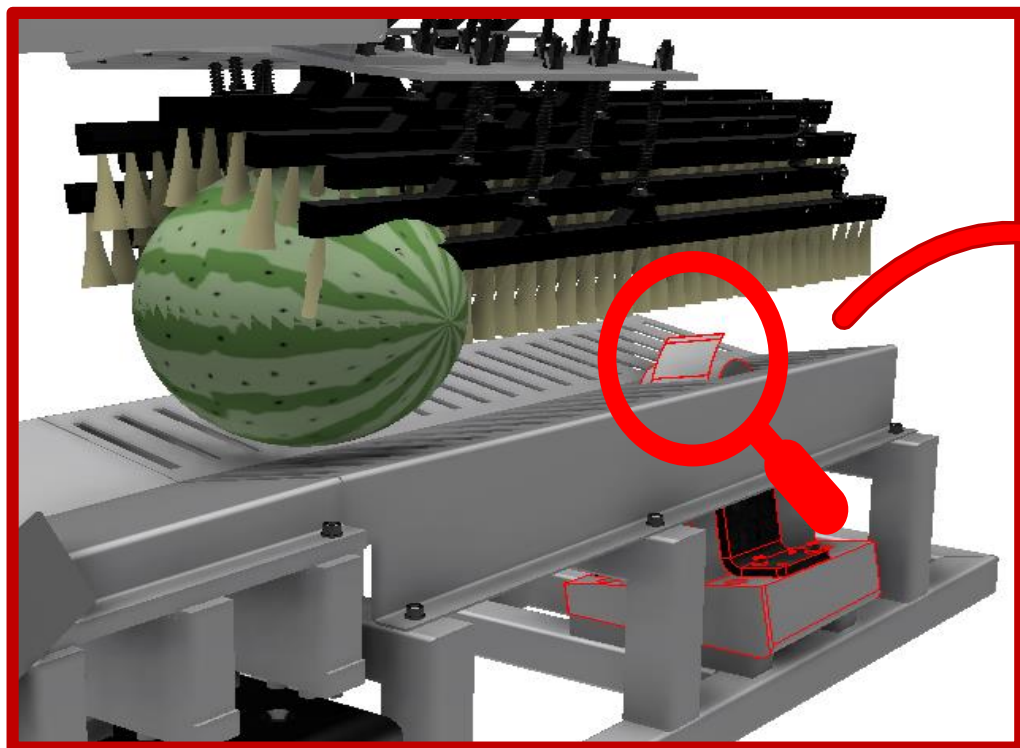

Fonte: Autor



QR CITRULINA

# SISTEMA DE ETIQUETAGEM

- ❖ O sistema desenvolvido, garante a descolagem da etiqueta do rolo
- ❖ Retorno por molas

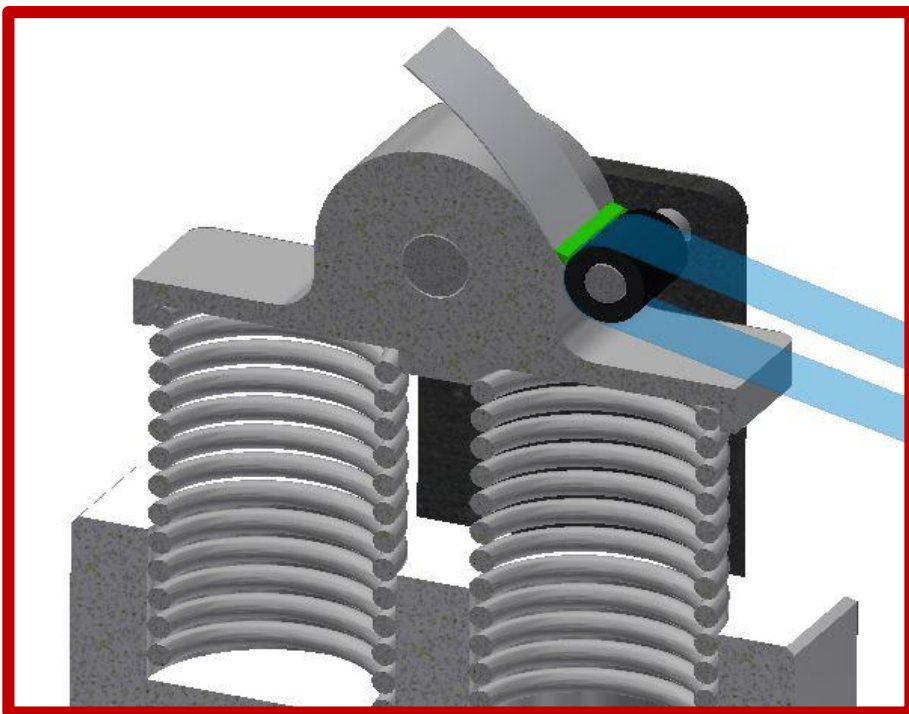

Fonte: Autor

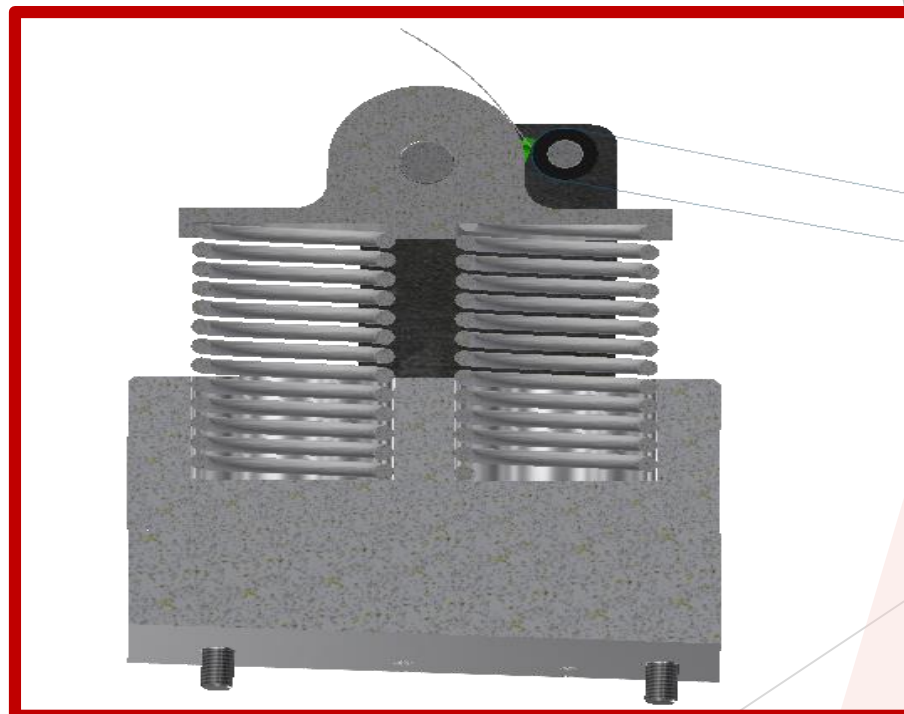

Fonte: Autor



QR CITRULINA

# SISTEMA DE ETIQUETAGEM

## Simulações rampa de rolagem para a etiquetagem

A: Transient Structural  
Equivalent Stress  
Type: Equivalent (von-Mises) Stress  
Unit: MPa  
Time: 2  
30/11/2020 12:28

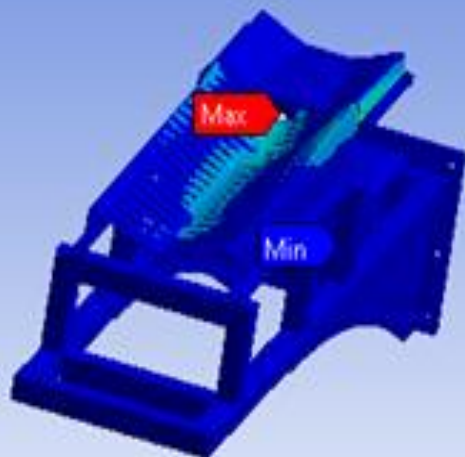
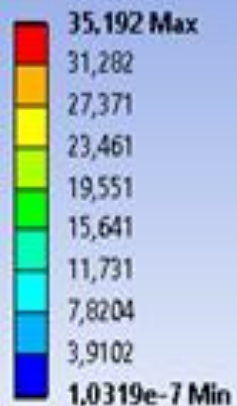

**Von Misses**  
**35 MPa**

Fonte: Autor

A: Transient Structural  
Maximum Shear Stress  
Type: Maximum Shear Stress  
Unit: MPa  
Time: 2  
30/11/2020 12:29

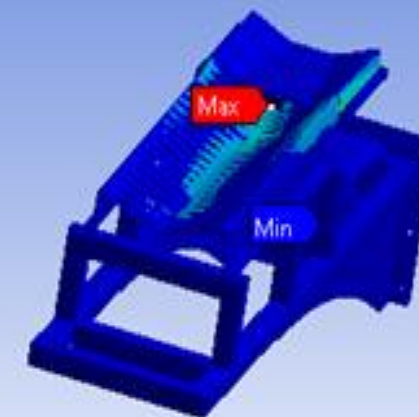
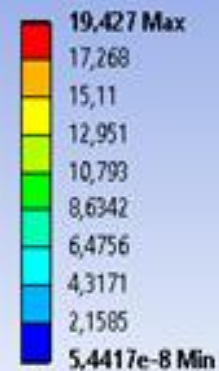

**Cisalhamento**  
**19,4 MPa**

Fonte: Autor



QR CITRULINA

# SISTEMA DE ETIQUETAGEM

## Simulações rampa de rolagem para a etiquetagem

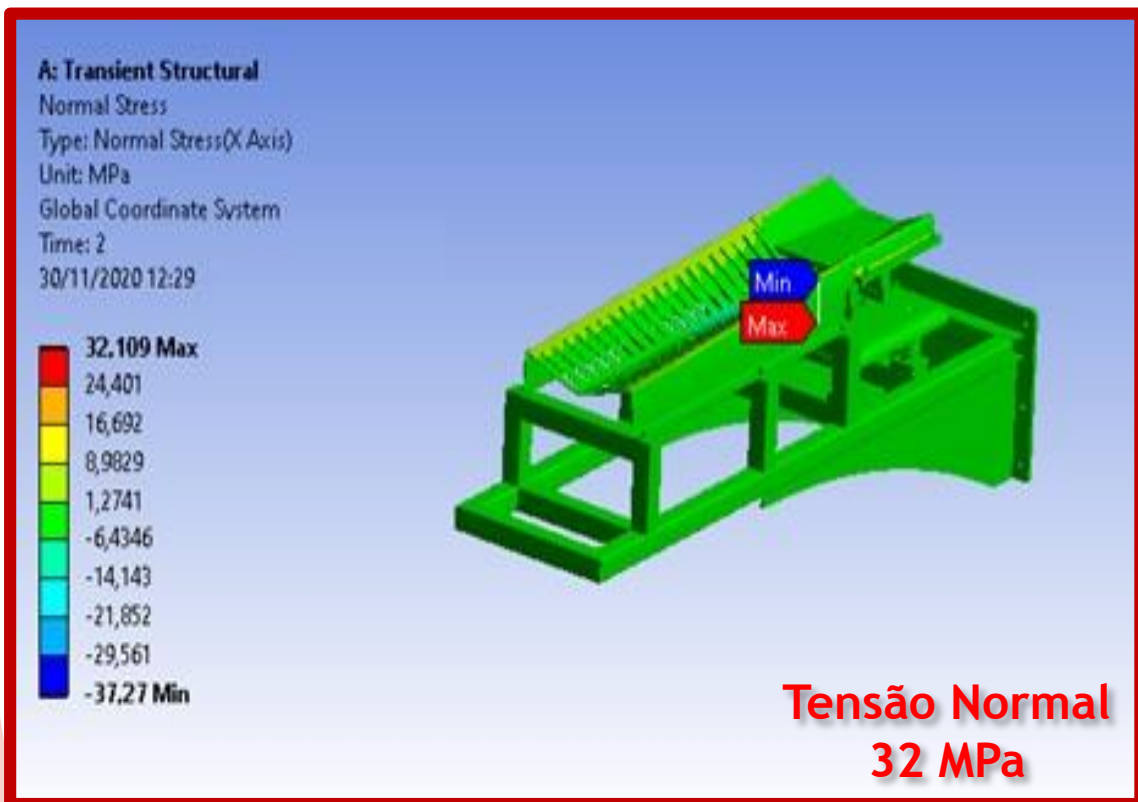

Fonte: Autor

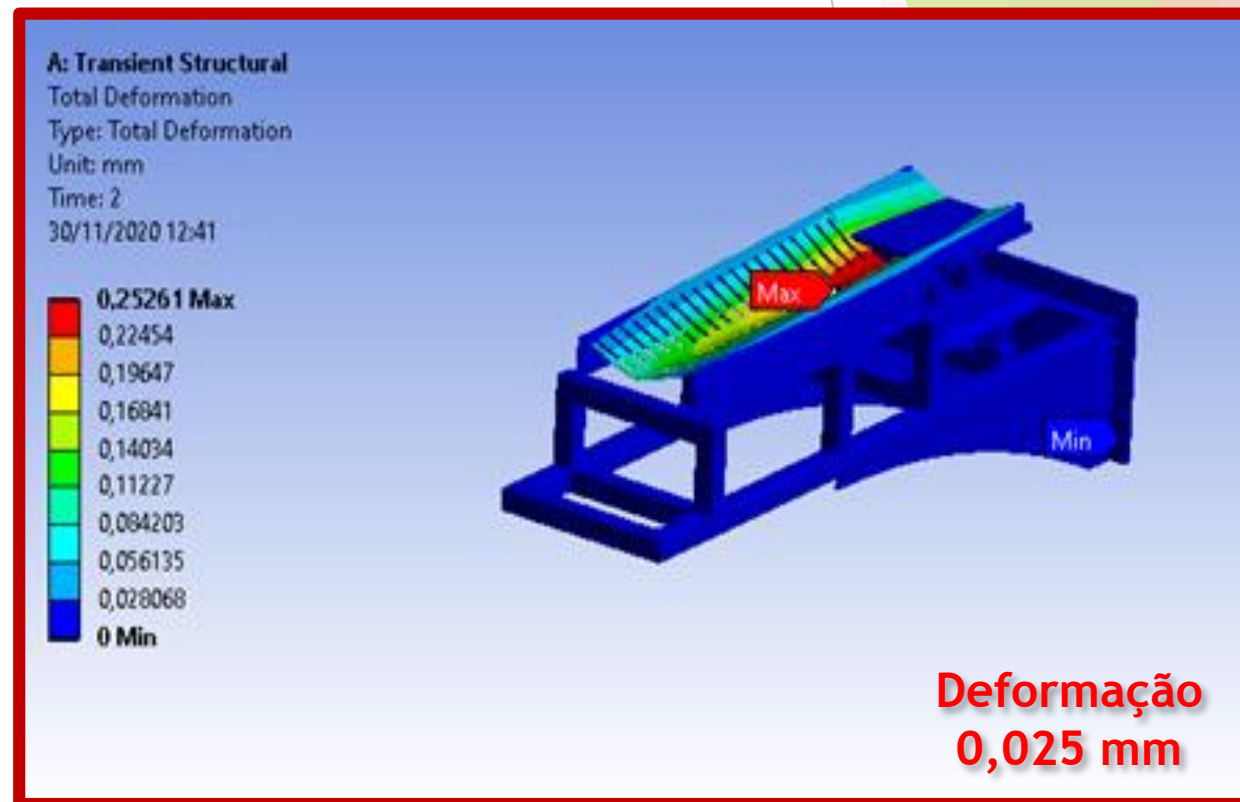

Fonte: Autor



QR CITRULINA

# SISTEMA DE ETIQUETAGEM



Dimensões básicas do sistema etiquetas

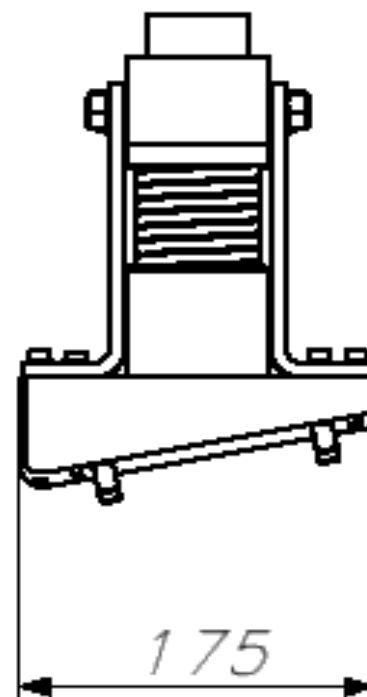
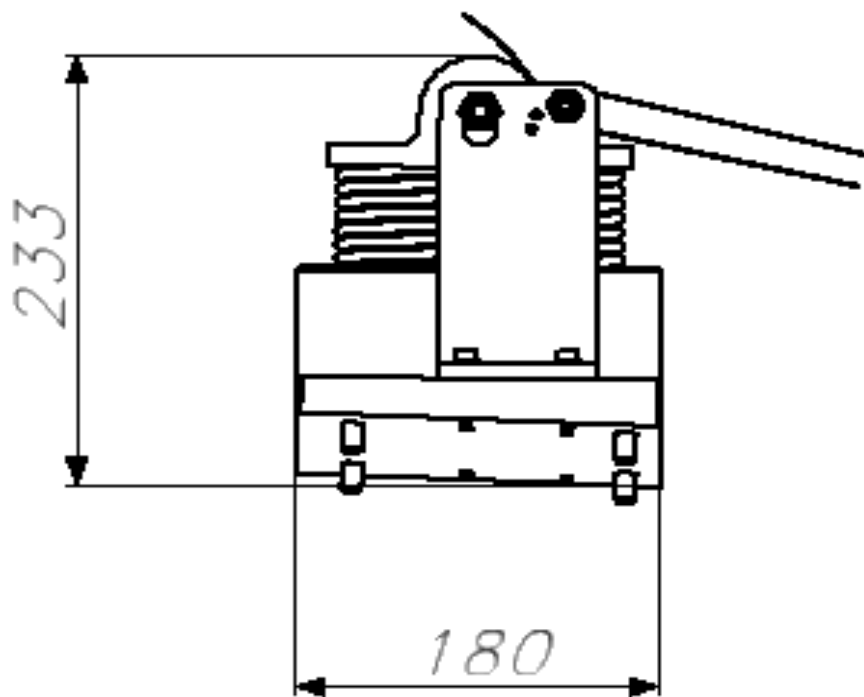



# SISTEMA DE ETIQUETAGEM

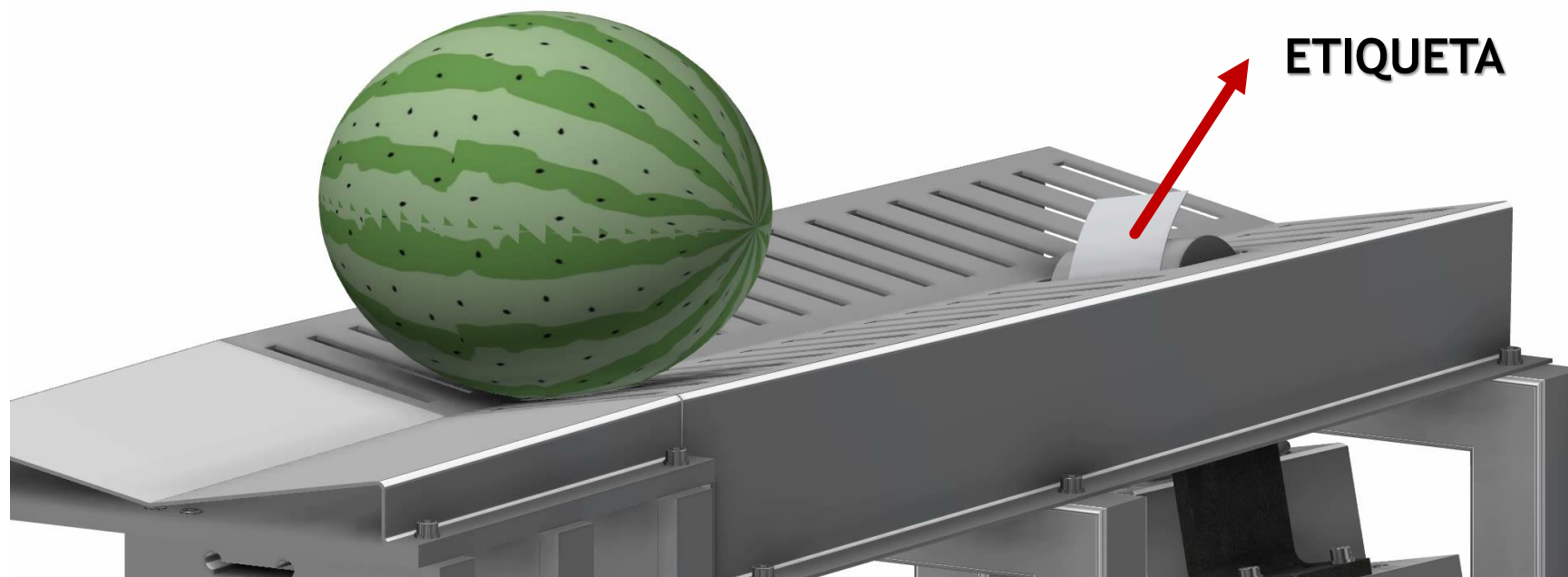

\*Video meramente ilustrativo



# DESEMPENHO OPERACIONAL

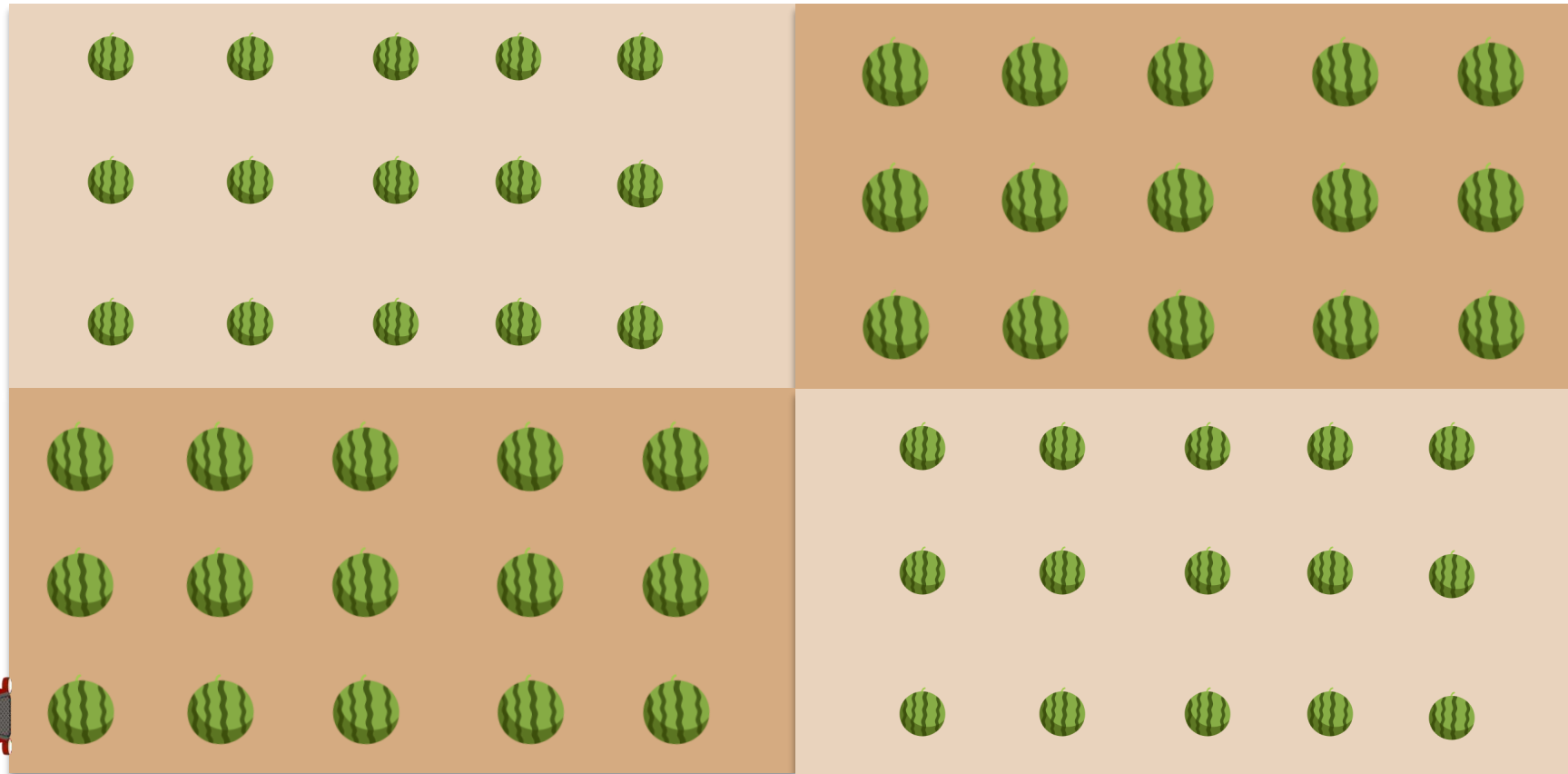

$$A_{colheita} = 1 \text{ ha}$$

$$v_{trator} = 2 \text{ km/h}$$

$$P_{m\u00e9dio} = 10 \text{ kg}$$





# VANTAGENS DO PROJETO

4 em 1



# VANTAGENS DO PROJETO

4

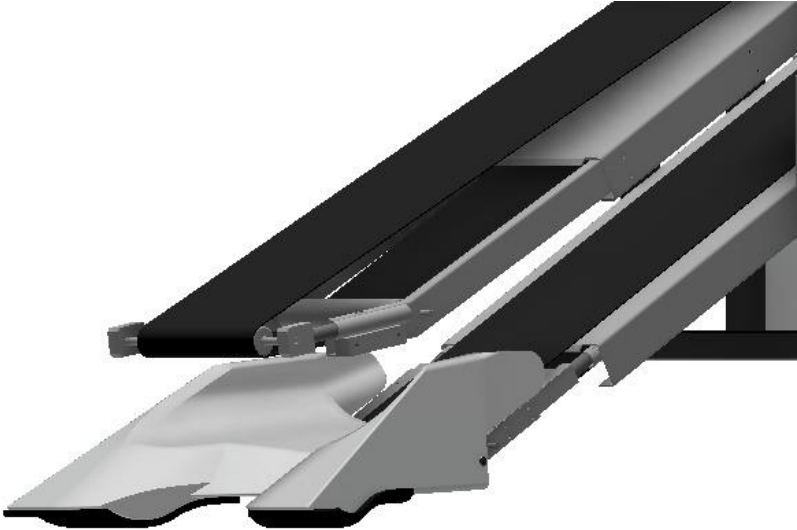



# VANTAGENS DO PROJETO

4

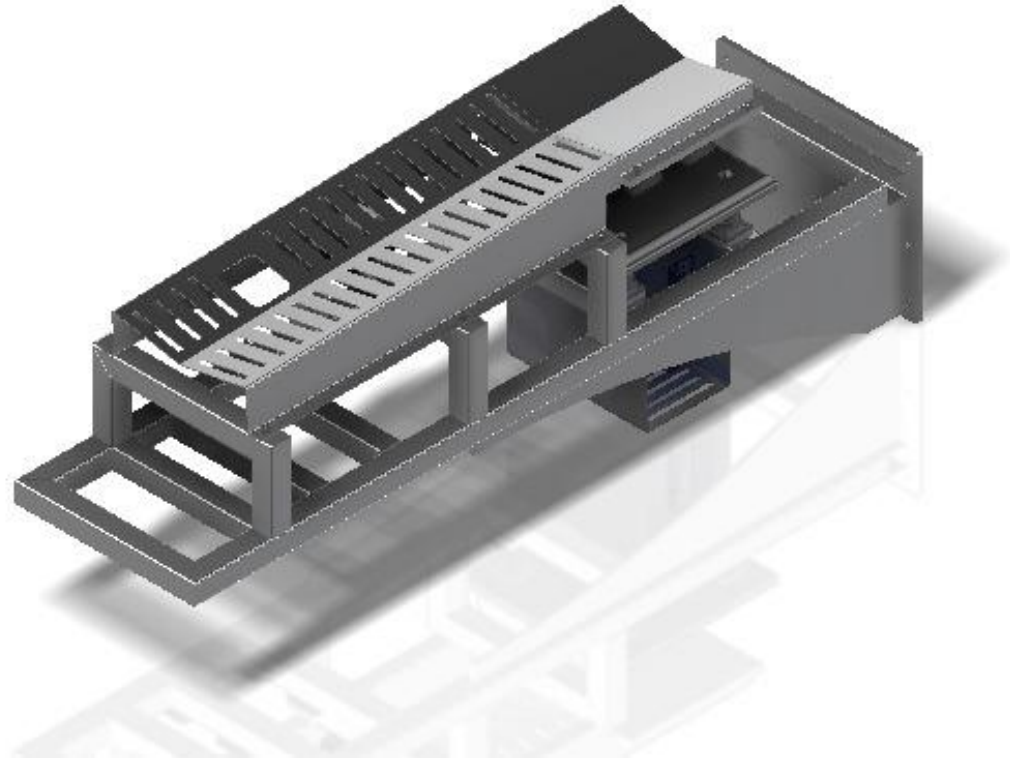



# VANTAGENS DO PROJETO

4

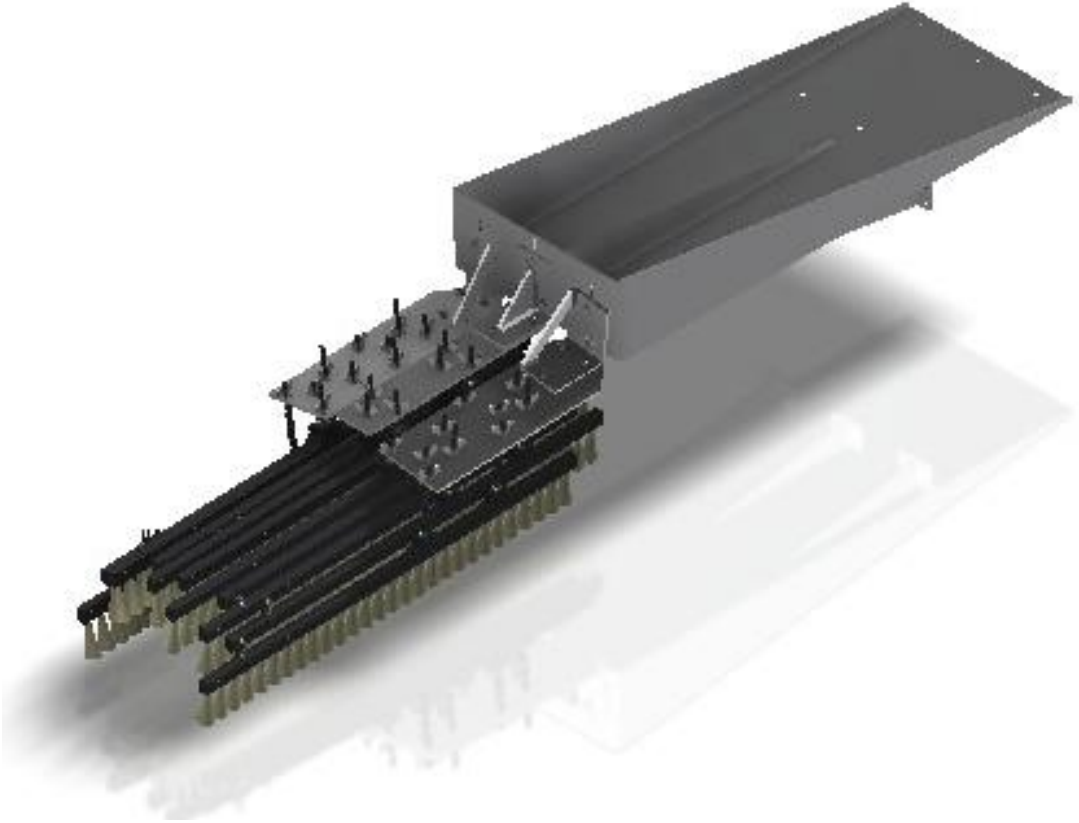



# VANTAGENS DO PROJETO

4

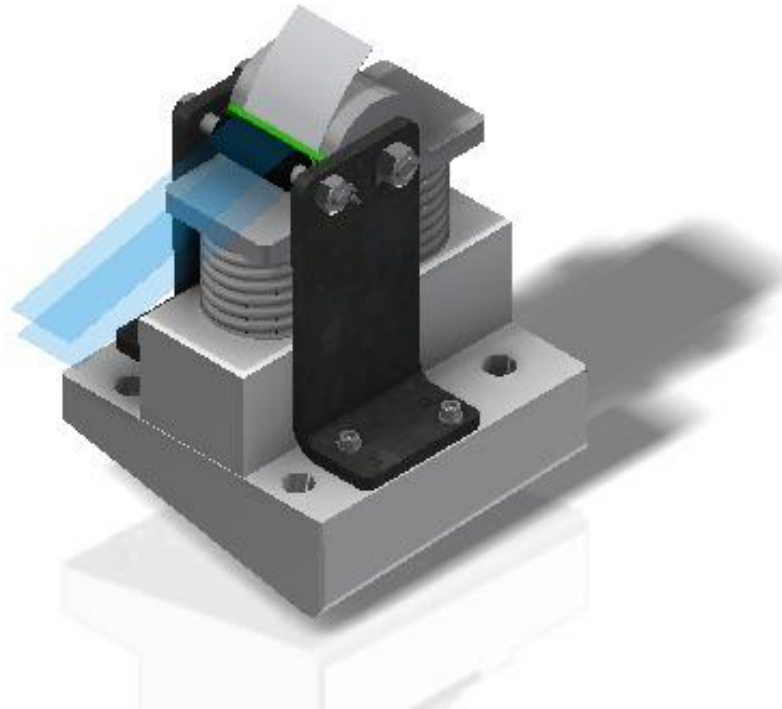



# VANTAGENS DO PROJETO

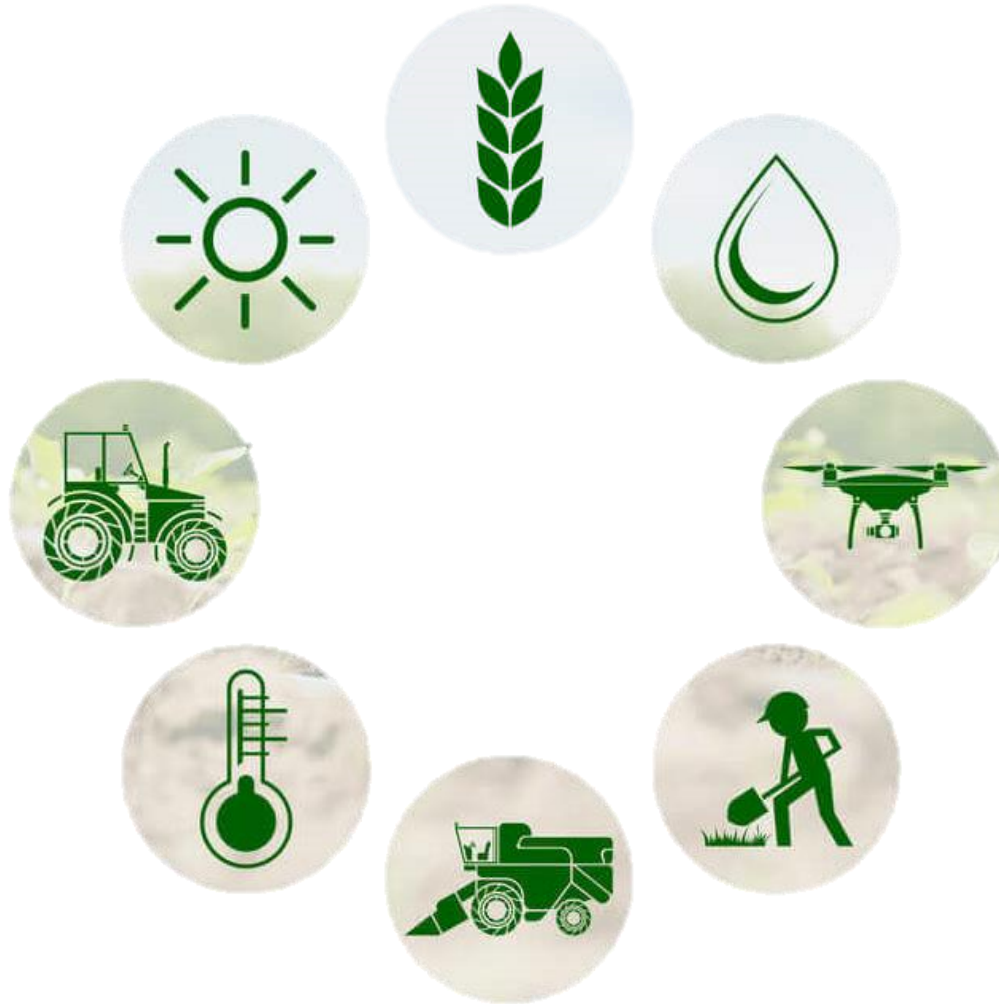



# DESAFIOS CONTINUIDADE DO PROJETO

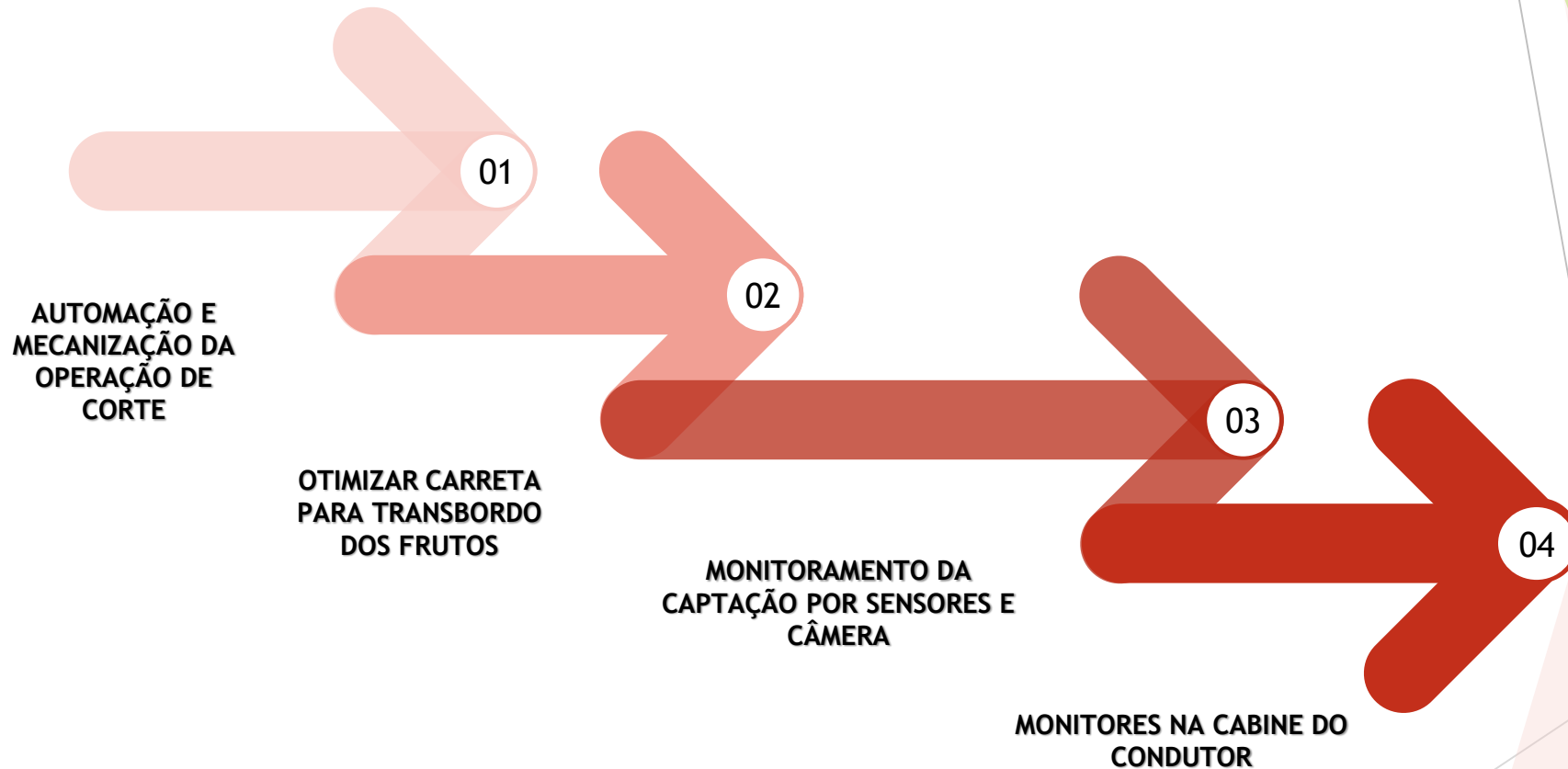



QR CITRULINA

# AGRADECIMENTOS

## ORIENTADOR

Profº.  
Dr. Carlos Rodrigues

## CO-ORIENTADOR

Profº.: Arnaldo Forgas

## INSTITUIÇÃO

Centro Universitario da FEI

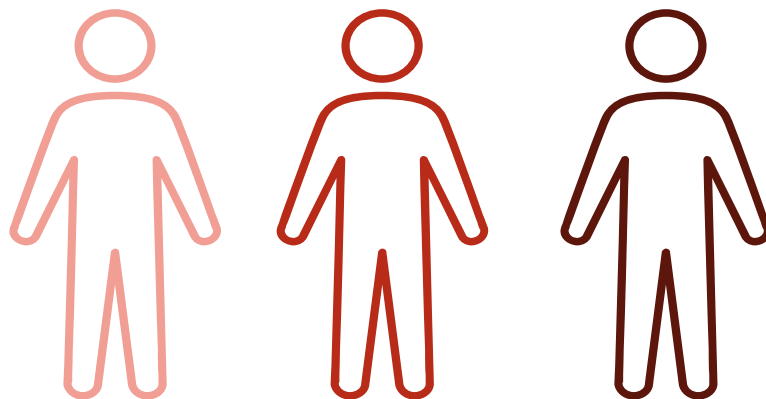





**INTEGRANTES:**

**André Luis Stevanatto**  
**Bruno Piva Gomes**  
**Emanuel Ciriaco**  
**Gabriel Cherubin**  
**Jeiel dos Santos Silva**  
**Jhonata Camilo**  
**Lucas Fabrício Silva Leal**  
**Lucas Felix dos Santos**  
**Marcello Maia**  
**Thiago Rocha**

**REGISTRO ACADÊMICO:**

**12.213.296-2**  
**12.113.392-0**  
**12.214.155-9**  
**12.114.601-3**  
**12.114.696-3**  
**12.115.503-0**  
**12.214.139-3**  
**12.113.171-8**  
**12.115.510-5**  
**12.118.806-4**

**ORIENTADOR: Professor Doutor Carlos Rodrigues dos Santos Neto**